

19 Hollywood Road Newport, NSW

5 

3 

3 

Level Golden Triangle paradise on over 1300sqm

Tucked away on a generous level landholding in Newport's prized Golden Triangle, this tightly-held home is ultra private and serenely located. It's embraced by sun soaked gardens with flat lawns and offers spacious family seclusion close to the beach.

Price:

Contact Agent



Tim Mumford

0421 942 693



Simone Sinclair

0405 470 250

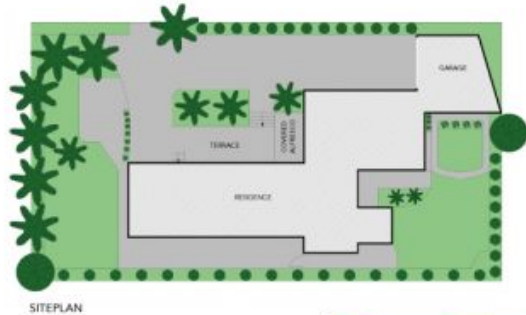

SITEPLAN



GROUND FLOOR

BASEMENT

INTERNAL AREA 297 M²
 EXTERNAL AREA 41 M²
 TOTAL AREA 338 M²

The site plan and floor plan is not to scale. Measurements are indicative and in metres. Bushes and trees are placed for illustration purposes only.



19 Hollywood Road, Newport
 stonerealestate.com.au