



14 Judith Street Seaforth, NSW

3

2

3

Weatherboard charm and character with north facing level rear garden

Beyond its alluring facade, this charming weatherboard cottage has been updated and extended to provide an effortlessly liveable family haven. Placed on 581sqm with level lawns and a gorgeous entertainers' pavilion bathed in northerly sun, it is a short stroll from parks, North Balgowlah Primary School and village.

Price:

Contact Agent



Maria Cassarino

0411 818 093



Chris Elliott

0410 416 066



GROUND FLOOR

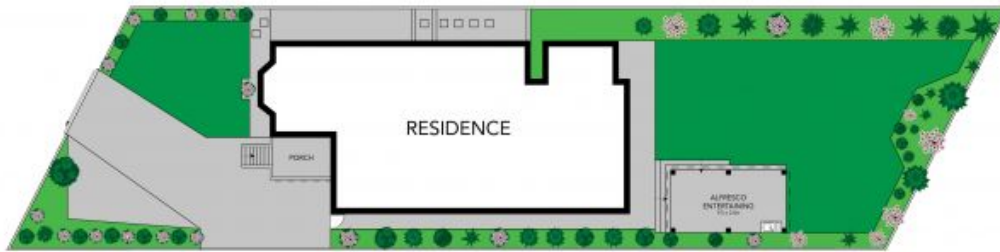

SITE PLAN (NOT TO SCALE)



All the information provided has been collected from reliable sources but cannot be guaranteed for accuracy. Interested persons should rely on their own enquiries. All dimensions are approximate and indicative only.



14 Judith Street, Seaforth