



12 Benelong Street Seaforth, NSW 4 2 2

Fabulous north facing family entertainer

Dressed in elegant timber posted verandahs with gorgeous street appeal, this dual level family home impresses with modern decor and fabulous entertaining areas. Set on a generous 676sqm with level private north rear lawn adjoining reserve, its tranquil setting is steps to the primary school with easy access to Seaforth Village.

Price:

Contact Agent



Maria Cassarino

0411 818 093



Chris Elliott

0410 416 066



GROUND FLOOR

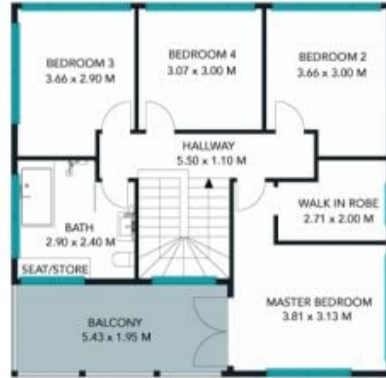

1 ST FLOOR



SITEPLAN

INTERNAL AREA 131 SQM
 EXTERNAL AREA 59 SQM
 TOTAL LIVING AREA 190 SQM
 TOTAL LAND AREA 676 SQM

The site plan and floor plan is not to scale. Measurements are indicative and in metres. Bushes and trees are placed for illustration purposes only.

12 Benelong Street, Seaforth

stonerealestate.com.au

Produced by DIAKRIT