



18 Monash Crescent Clontarf, NSW



Trophy family residence metres from Clontarf Beach

Fusing classic elegance with contemporary style, this superbly designed home provides a haven of relaxed luxury and spectacular entertaining. Embraced by private level landscaped gardens, it is nestled in one of Sydney's most exclusive cul-de-sacs.

Price:

Contact Agent



Maria Cassarino

0411 818 093



Phillip Wright

0488 586 860

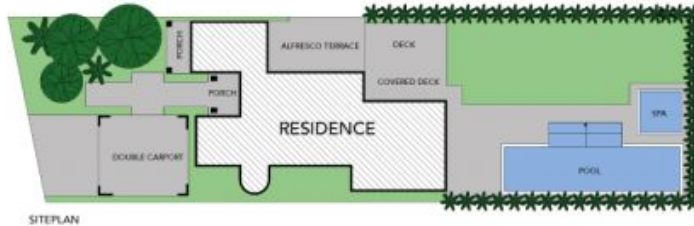

SITEPLAN



FIRST FLOOR



GROUND FLOOR

INTERNAL AREA 374 SQM
EXTERNAL AREA 284 SQM
TOTAL AREA 658 SQM

The site plan and floor plan is not to scale. Measurements are indicative and in metres. Bushes and trees are placed for illustration purposes only.



18 Monash Crescent, Clontarf

stonerealestate.com.au

Produced by DIAKRIT



FIRST FLOOR



GROUND FLOOR



The interior style and design of this floor plan is designed for inspiration purposes to show the living spaces. It is not an exact replica of the furniture and fittings in the home.

18 Monash Crescent, Clontarf
stonerealestate.com.au

Produced by **DIAKRIT**