



53/29 The Crescent Manly, NSW

2 1 1

### Idyllic waterfront apartment

Perched high in a boutique waterfront building is this superb, light filled apartment offering an unbeatable carefree lifestyle, sensationally positioned on the foreshores of Manly Cove just two minutes walk to the beach and Manly Wharf.

**Price:** Contact Agent  
**Council Rates:** \$360.00 p/q  
**Water Rates:** \$168.00 p/q



**Tim Mumford**

0421 942 693



**James Hayward**

0406 447 344

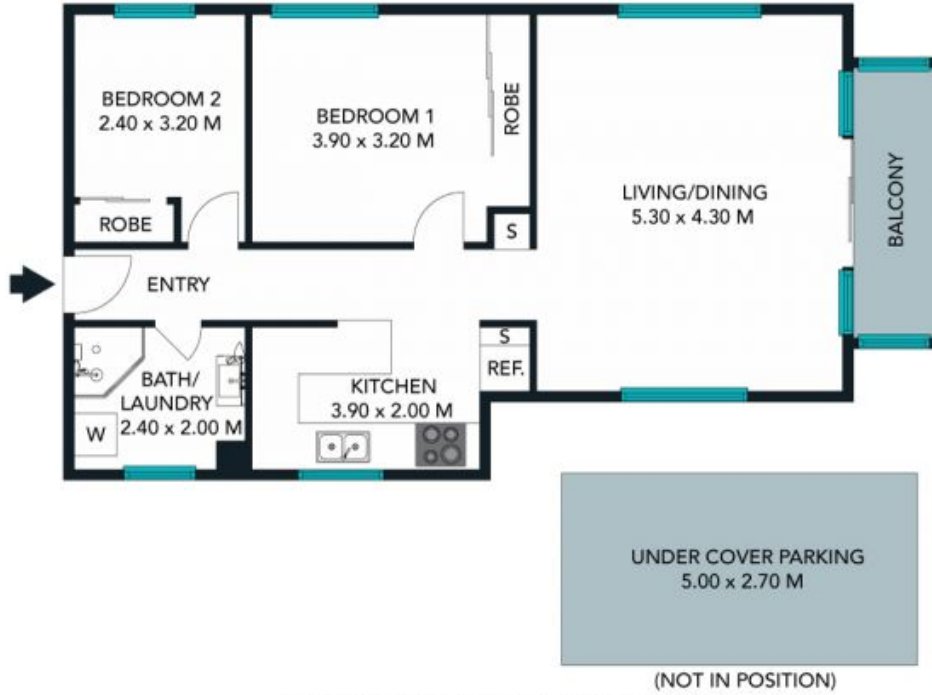

The floor plan is not to scale. Measurements are indicative and in metres.



53/29 The Crescent, Manly  
stonerealestate.com.au

Produced by DIAKRIT



The interior style and design of this floor plan is designed for inspiration purposes to show the living spaces. It is not an exact replica of the furniture and fittings in the home.

53/29 The Crescent, Manly  
stonerealestate.com.au

Produced by DIAKRIT