



204/10 West Promenade Manly, NSW



Light and quality in a unique position

Facing due north and enjoying an ever changing outlook over Manly Oval, this secure modern apartment is a superb lifestyle proposition. The residence showcases high quality finishes throughout and provides direct access to Manly's vibrant heart.

Price: \$700 per week

Bond: \$2,800

Available Date: 16/09/2017

Stone Manly

02 8962 2200

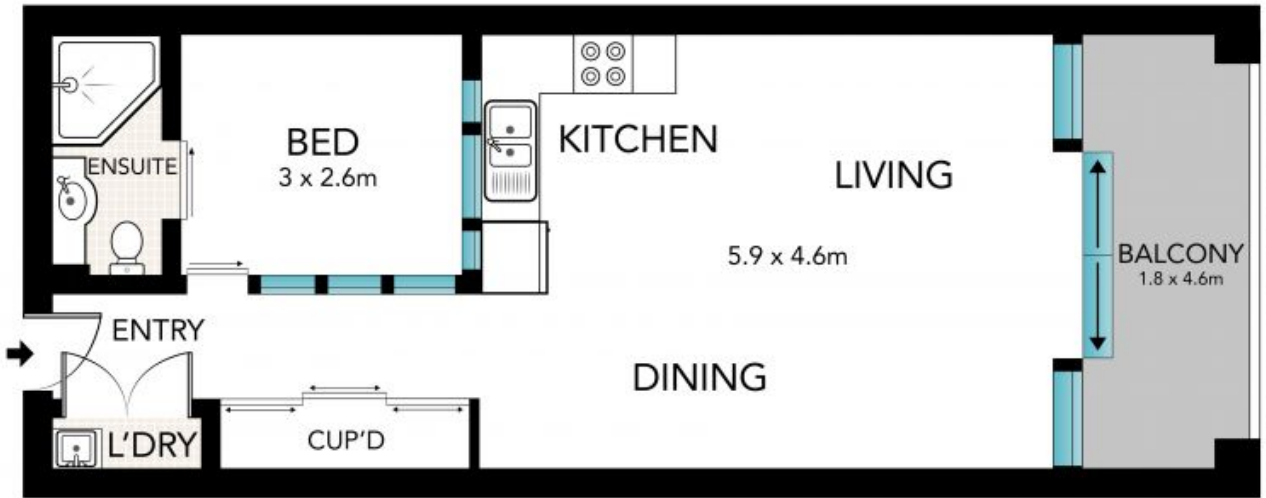

LEVEL TWO



SCALE (METRES)

All the information provided has been collected from reliable sources but cannot be guaranteed for accuracy. Intended solely for your own enquiries. All dimensions are approximate and relative only.



204/10 West Promenade, Manly