



9 Cramer Place Glenwood, NSW

4 2 2

Expansive family home with north aspect

Spread over two levels, this large family home is positioned on a level block with a coveted north to rear aspect. Situated in a peaceful family enclave, close to Glenwood Lake playground, within the Glenwood High and Parklea Public school catchments.

Price: Auction Guide \$855,000



Belinda Shearer

0404 479 199



GROUND FLOOR



FIRST FLOOR

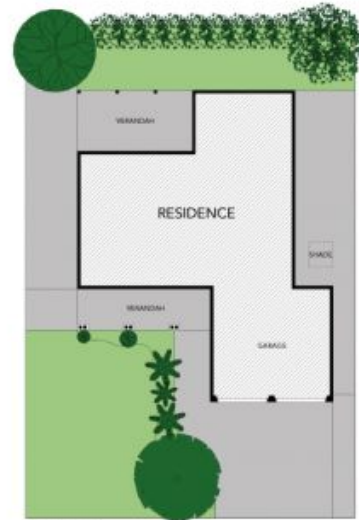

SITEPLAN



The site plan and floor plan is not to scale. Measurements are indicative and in metres. Bushes and trees are placed for illustration purposes only.

9 Cramer Place, Glenwood
 stonerealestate.com.au

Produced by DIAKRIT



GROUND FLOOR



FIRST FLOOR

The interior style and design of this floor plan is designed for inspiration purposes to show the living spaces. It is not an exact replica of the furniture and fittings in the home.

9 Cramer Place, Glenwood
stonerealestate.com.au

Produced by DIAKRIT

