

9/43 East Esplanade Manly, NSW

2 2 1

Harbourfront entertainer with wondrous water views

A lifestyle of luxury and convenience beckons in this sleek and stylish dual level apartment set to a dazzling harbour and city skyline backdrop. From its exclusive location directly opposite Manly Wharf, its only footsteps to beaches and eateries.

Price: Price Guide \$1,490,000



Candice Cattell

0417 311 777



Tim Mumford

0421 942 693

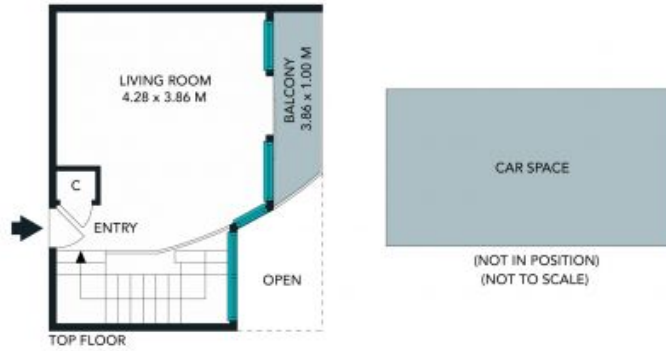

The floor plan is not to scale. Measurements are indicative and in metres.





GROUND FLOOR



TOP FLOOR

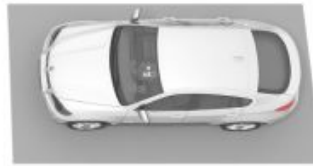

The interior style and design of this floor plan is designed for inspiration purposes to show the living spaces. It is not an exact replica of the furniture and fittings in the home.

9/43 East Esplanade, Manly
stonerealestate.com.au

Produced by DIAKRIT