



4/239 Macpherson Street Warriewood, NSW

3 2 2

Peaceful, north facing townhouse

This spacious townhouse in boutique 'Wattle Grove' is a private oasis amidst leafy surrounds in a quiet, convenient location. Ideal for a young family, couple or investor, its serene setting is only moments to shops, schools, city buses and beaches.

Price: Price Guide \$1,100,000
Council Rates: \$371.55 p/q
Water Rates: \$171.98 p/q
Strata Rates: \$829.50 p/q



Judy Fitzgerald

0422 651 655



Greg Duce

0409 749 287

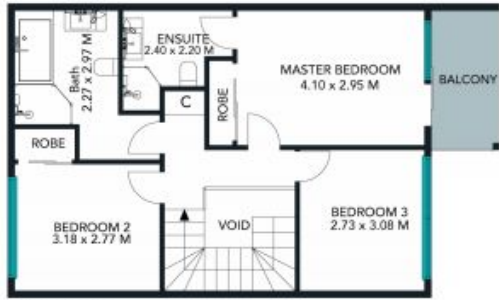

1ST FLOOR

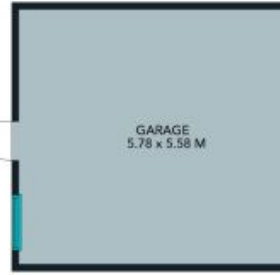

(NOT IN POSITION)



SITEPLAN

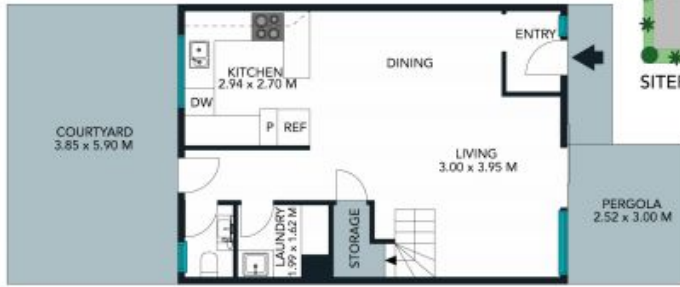

GROUND FLOOR

TOTAL LAND AREA : 400 SQM
 TOTAL LIVING AREA : 100 SQM

The site plan and floor plan is not to scale. Measurements are indicative and in metres. Bushes and trees are placed for illustration purposes only.



4/239 Macpherson Street, Warriewood
 stonerealestate.com.au

Produced by DIAKRIT



1ST FLOOR



GROUND FLOOR

The interior style and design of this floor plan is designed for inspiration purposes to show the living spaces. It is not an exact replica of the furniture and fittings in the home.



4/239 Macpherson Street, Warriewood
stonerealestate.com.au

Produced by DIAKRIT