

3/6a Rangers Avenue Mosman, NSW



Elegant Art-Deco living

Enjoying a prime top-floor position within the boutique 'Careena' Art Deco building holding just four residences. This superb character three bedroom apartment wraps around the entire left side of the building and offers spacious interiors with elegant finishes, superbly placed with easy stroll to shops and transport.

Price: Contact Agent
Council Rates: \$343.00 p/q
Water Rates: \$171.00 p/q
Strata Rates: \$855.00 p/q



Tim Mumford

0421 942 693



James Hayward

0406 447 344

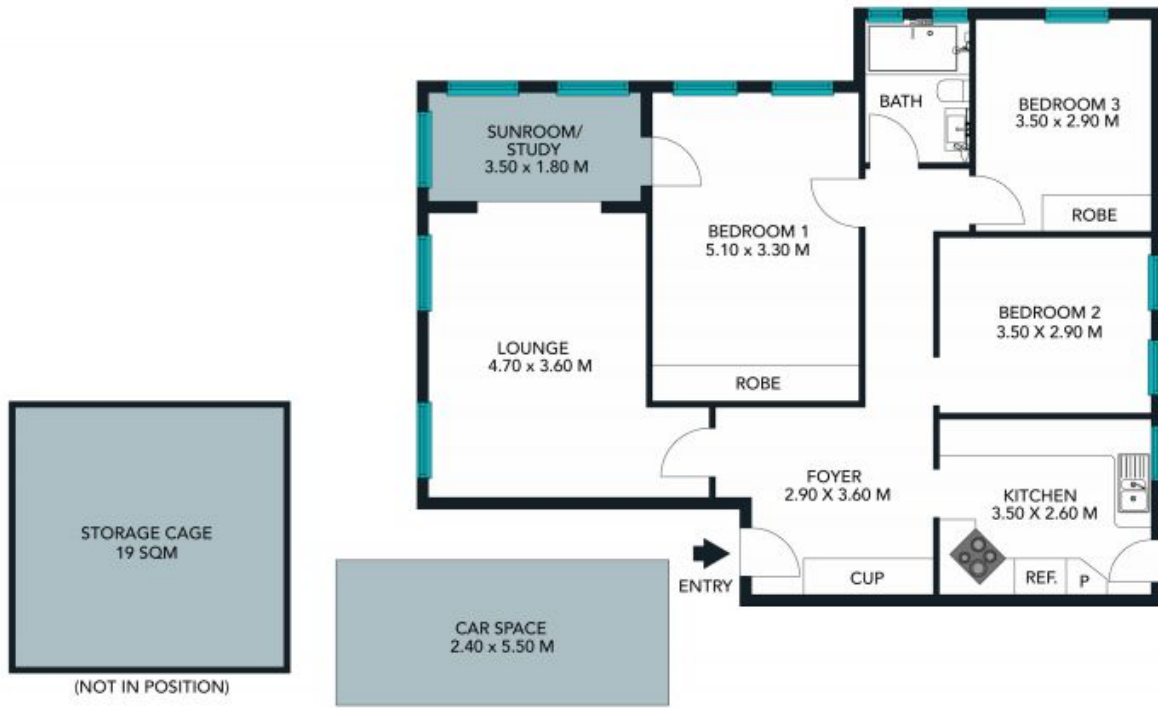

The floor plan is not to scale. Measurements are indicative and in metres.

TOTAL SQM : 127 SQM



3/6a Rangers Avenue, Mosman, Mosman
 stonerealestate.com.au

Produced by DIAKRIT



The interior style and design of this floor plan is designed for inspiration purposes to show the living spaces. It is not an exact replica of the furniture and fittings in the home.

3/6a Rangers Avenue, Mosman, Mosman
stonerealestate.com.au

Produced by DIAKRIT