

22/35 Dalley Street Queenscliff, NSW



Bright, breezy and ultra-convenient

Awash with natural light and crowned by a 53sqm rooftop entertainers' terrace, this townhouse-style apartment makes an instant impression. It enjoys wide district views back towards the city and is only a few minutes' walk to village shops and the beach.

Price: \$1,267,500



Eddy Piddington

0414 333 907

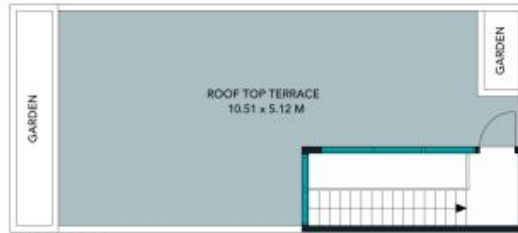
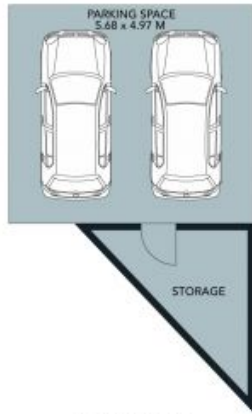

2ND FLOOR



GROUND FLOOR



1ST FLOOR

The floor plan is not to scale. Measurements are indicative and in metres.





2ND FLOOR



GROUND FLOOR



1ST FLOOR

The interior style and design of this floor plan is designed for inspiration purposes to show the living spaces. It is not an exact replica of the furniture and fittings in the home.

