



15 Girvan Crescent Corrimal, NSW 3 1 2

Tightly-held home with scenic views

This beautifully presented home holds an elevated position with panoramic coastal, ocean and city views. Lovingly maintained by the original owner, it offers a great family lifestyle and is ready to move in and enjoy with nothing further to be done.

Price:

Price Guide \$880,000



Joe Paiano

0417 124 313



Joe Paiano

0417 124 313

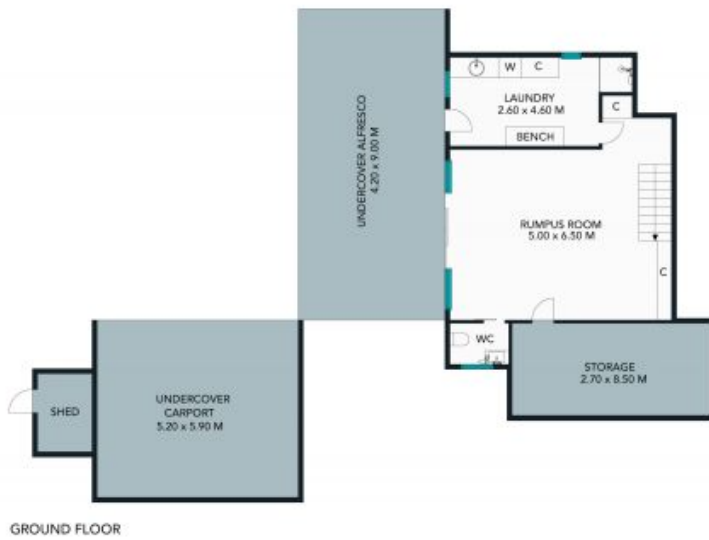

TOTAL LAND AREA : 556 SQM
 TOTAL LIVING AREA : 204 SQM

The site plan and floor plan are not to scale; measurements are indicative and in metres. Bushes and trees are placed for illustration purposes. Plans should not be relied on. Interested parties should make and rely on their own enquiries.

15 Girvan Crescent, Corrimal
 stonerealestate.com.au

Produced by DIAKRIT

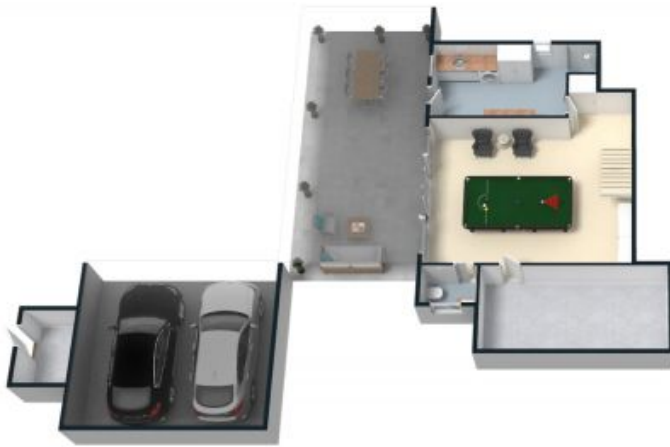

GROUND FLOOR



FIRST FLOOR



The floor plan is not to scale; measurements are indicative and in metres. All features included in this 3D plan are for inspiration purposes only. This is not an exact replica of the property or the position of exterior elements. Plans should not be relied on. Interested parties should make and rely on their own enquiries.

15 Girvan Crescent, Corrimal
stonerealestate.com.au

Produced by **DIAKRIT**