

6 Montreal Avenue Killara, NSW

6

4

2

Grand family entertainer in parkside setting

Positioned in a whisper quiet street, this generously appointed family home spans three levels, boasting a wealth of accommodation and versatile floorplan, it comes complete with a fully self-contained lower level ideal for teens, in-laws or au pair.



Steven Kourdis

0402 555 675



Ryan Woo

0410 884 680

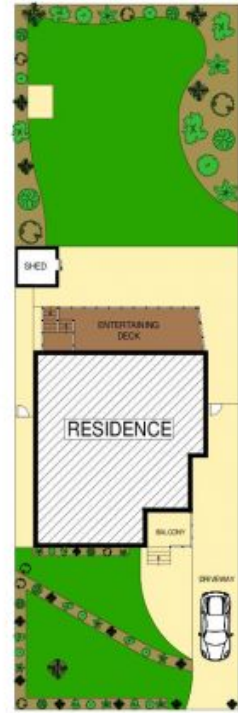
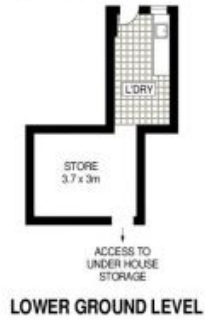

Dimensions are approximate. All information contained is gathered from sources we believe to be reliable. However we cannot guarantee its accuracy and interested persons should rely on their own enquiries.
www.vicorphoto.com.au



6 MONTREAL AVENUE, KILLARA
APPROX. INTERNAL FLOOR AREA: 302 SQM

