



131 McCarrs Creek Road CHURCH POINT, NSW 4  3  2 

**Rare Find**

Japanese Styled family home located in tranquil Church Point with a picturesque, leafy outlook. Masterful use of natural timbers and stone make this home a delight to live in. Multiple outdoor deck areas and ideal floor plan allow for flexible living and entertaining. The most convenient Northern Beaches location with express buses to the CBD and great car access.

**Price:** \$1,150,000

**Stone Mona Vale**

02 8030 8549

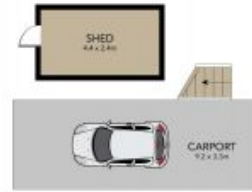
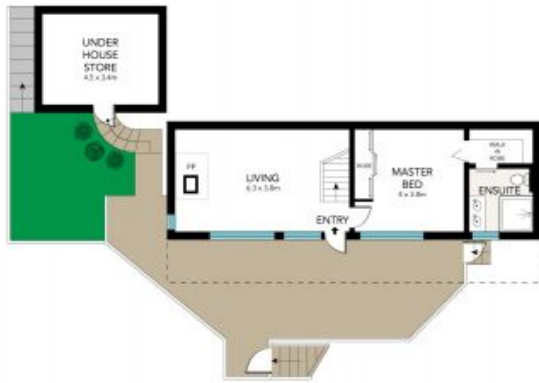

LOWER ENTRY LEVEL



ENTRY LEVEL

FIRST LEVEL



SITE PLAN (NOT TO SCALE)

SCALE (METRES)

All the information provided has been collected from reliable sources but cannot be guaranteed for accuracy. Interested persons should rely on their own enquiries. All dimensions are approximate and indicative only.

131 MCCARRS CREEK ROAD, CHURCH POINT

