



56 Mona Vale Road MONA VALE, NSW

3

1

2

SINGLE LEVEL FAMILY HOME

Facing North and situated on a large 700sqm block, this single level family home is close to Mona Vale shops, schools, and transport. The combined lounge and dining area with polished floors opens out to a large covered alfresco deck with built in spa, perfect for entertaining. There are 3 bedrooms all with built in robes, a full bathroom with separate 2nd toilet and two living areas. The gas kitchen has been recently renovated and features stainless steel appliances. Other attributes of this home include; landscaped gardens, electronic gate, fully fenced yard, reverse cycle air conditioning, lock up storage shed, double carport and off street parking for plenty of cars.

Price: 730,000



Trent McKay

0419 288 867

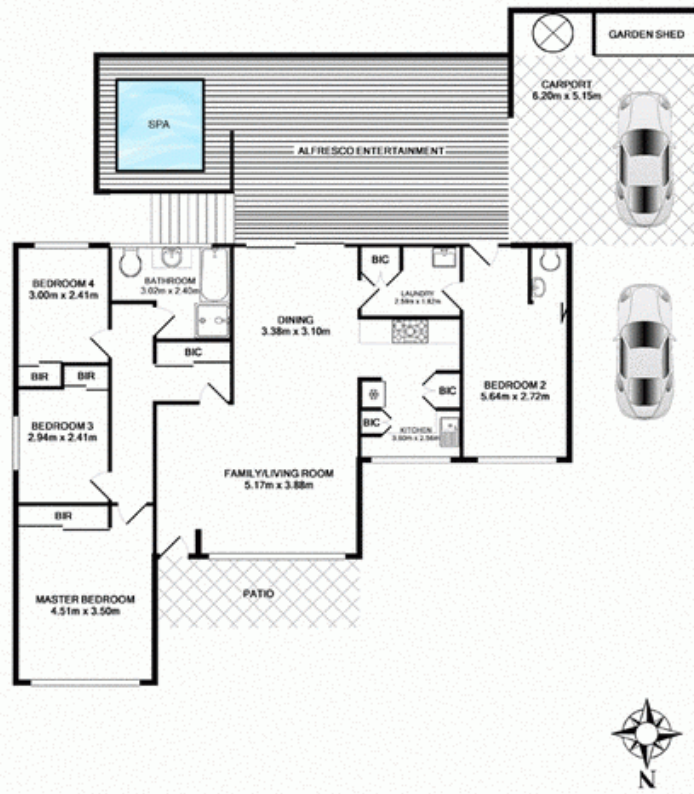

56 Mona Vale Road, Mona Vale

TOTAL APPROX. FLOOR AREA 163.2 SQ.M. (1757 SQ.FT.)
 Measurements are approximate. Not to Scale. For illustrative purposes only.