



41 Valley View Circuit WARRIEWOOD, NSW

5 

2 

2 

Stylish Family Living

Price: \$1,075,000



**Greg Duce**

0409 749 287

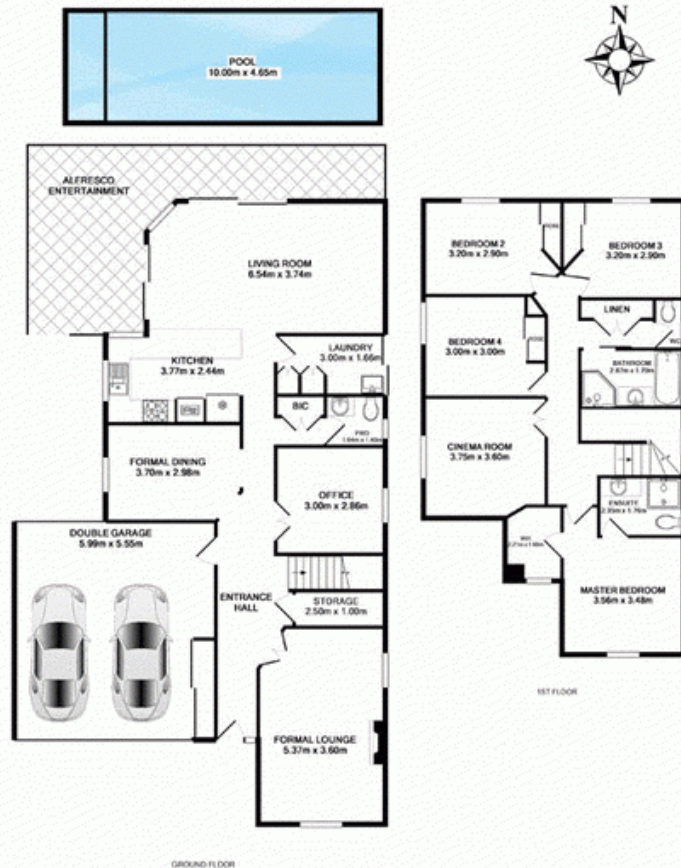

GROUND FLOOR

## 41 Valley View Cct, Warriewood

TOTAL APPROX. FLOOR AREA 247.2 SQ.M. (2661 SQ.FT.)  
Measurements are approximate. Not to Scale. For illustrative purposes only.