

6 Baree Place WARRIEWOOD, NSW

3

1

2

Cul-de-sac Living

Attention builders: Located in a beautifully quiet cul-de-sac yet only minutes from shopping centres, beach, schools and parks is this great first home. Filled with natural light, the living area boasts floor to ceiling windows, air conditioning, gas heating and is highlighted by polished hardwood floors and a timber balcony. The 3 bedrooms adjoin a modern family bathroom with spa bath perfect for a young family.

Price:

Offers Over \$690,000



Trent McKay

0419 288 867

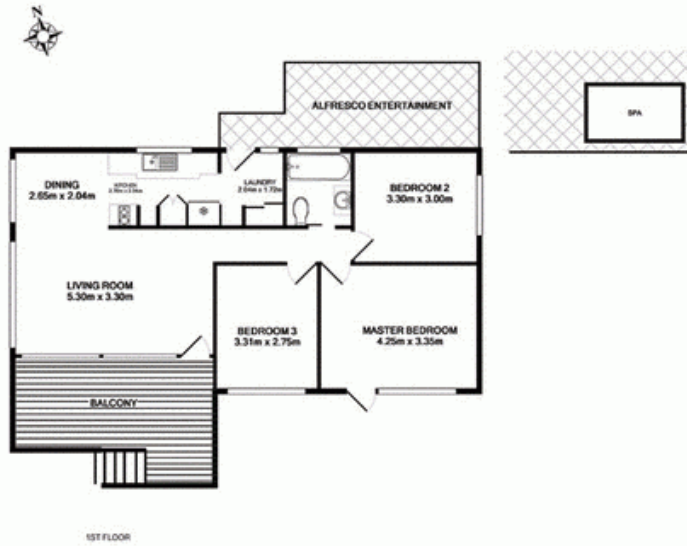

1ST FLOOR

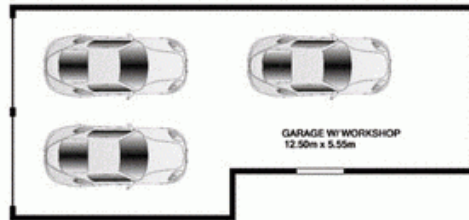

GROUND FLOOR

6 Baree Place, Warriewood

*TOTAL APPROX. FLOOR AREA 102.8 SQ.M. (1089 SQ.FT.)
Measurements are approximate. Not to Scale. For illustrative purposes only.