



14 Campbell Avenue CROMER, NSW



Immaculate Single Level Family Home

Filled with natural light from the North, South and East aspects is this immaculate 3 bedroom home. Step inside to an inviting entrance hall opening to an expansive living and dining area, boasting reverse cycle air conditioning, gas heating, down lights and glass doors out to a private front patio framed by a manicured front yard.

Price:

Offers Over \$780,000

Stone Mona Vale

02 8030 8549

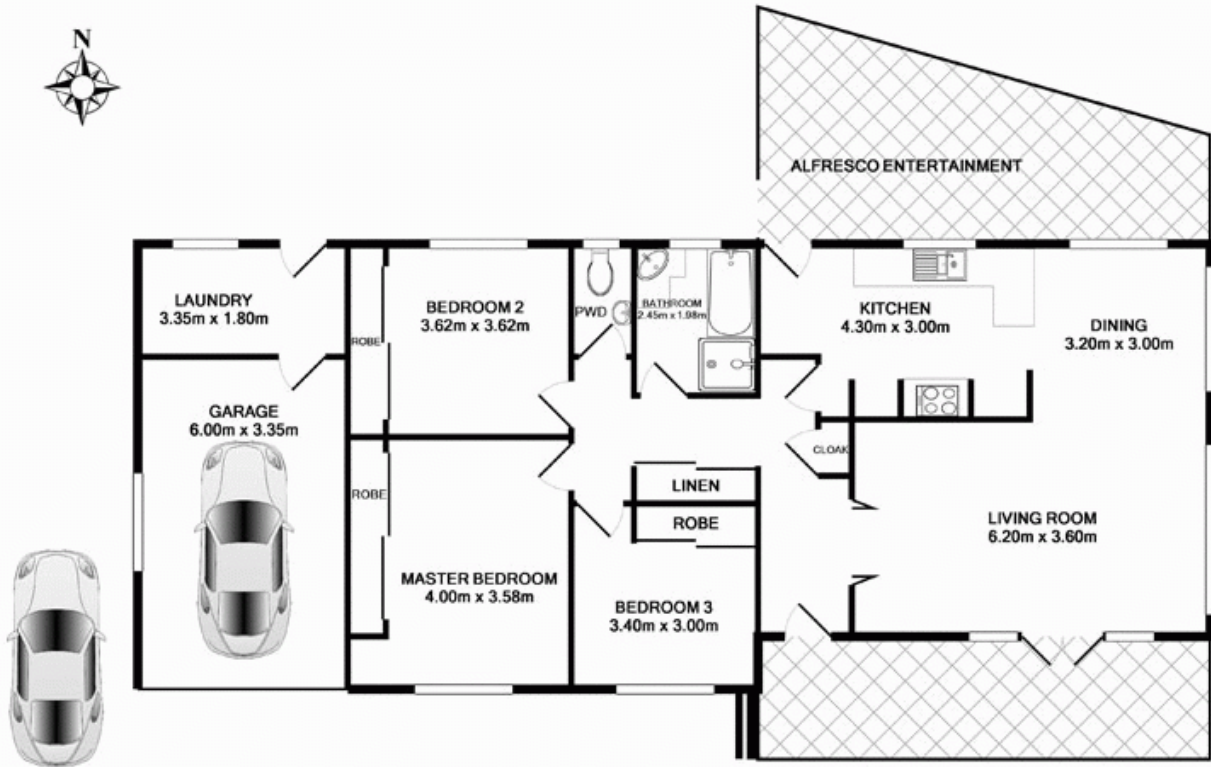

14 Campbell Avenue, Cromer

TOTAL APPROX. FLOOR AREA 115.5 SQ.M. (1243 SQ.FT.)
Measurements are approximate. Not to Scale. For illustrative purposes only.