



98 Edgecliffe Boulevard COLLAROY PLATEAU, NSW

4

3

2

Premium Home Living

With stunning street appeal this brick home has been beautifully maintained, from the picturesque gardens to the modern improvements inside. Facing due north, the private front yard boasts distinctive landscaping and unique garden features surrounding a generous entertainers patio. There is also access to the adjoining reserve, for extra space and more privacy from the street. Perfect for a busy, growing family downstairs is equipped with an extensive formal living, dining, casual meals area and family room for the kids.

Price:

Offers Over \$1,150,000



Trent McKay

0419 288 867

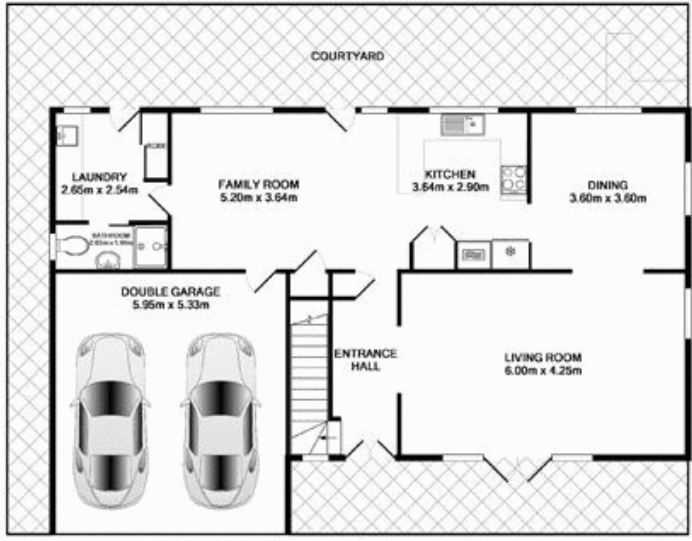

GROUND FLOOR



1ST FLOOR



98 Edgecliffe Boulevard, Collaroy Plateau

TOTAL APPROX. FLOOR AREA 193.5 SQ.M. (2083 SQ.FT.)
 Measurements are approximate. Not to Scale. For illustrative purposes only.