

55 Wesley Street ELANORA HEIGHTS, NSW

3

1

1

Private and Quiet Family Haven

Leave your worries at the front door as you enter this carefree single level family home. Boasting a convenient floorplan and that warm homely feel throughout, this property is perfect for the young busy family.

Price: offers over \$760,000

Stone Mona Vale

02 8030 8549

3 1 1

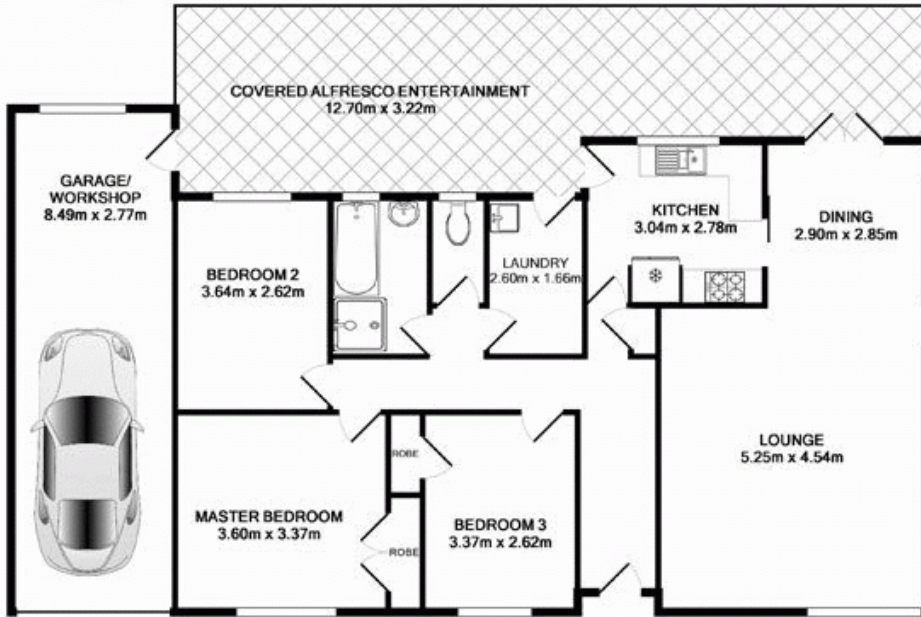

55 Wesley Street, Elanora Heights

TOTAL APPROX. FLOOR AREA 117.5 SQ.M. (1265 SQ.FT.)
Measurements are approximate. Not to Scale. For illustrative purposes only.