



91 Blandford Street COLLAROY PLATEAU, NSW

3

1

3

Family Home in a Sought After Location

Position, position, position! Why not enjoy your morning walks along the famous Edgecliff Blvde, located about as far North as you can get on Blandford street. On a large level block, this fantastic single level, brick home is filled with natural light and warmth from all four aspects.

Step inside from a generous north facing patio to an expansive living area adjoining a tidy functional kitchen and separate formal dining room.

All 3 bedrooms are of good size and include built-in wardrobes, while both the 2nd bedroom and master bedroom flow seamlessly onto a northerly balcony perfect for late Sunday breakfasts or to relax after work and watch the sun set.

Other attributes include: new carpet & paint, triple carport, a large workshop and private level rear yard.

Price: \$1,050,000



Greg Duce

0409 749 287

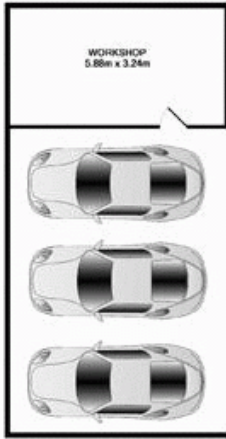

3 CAR GARAGE
8.20m x 5.88m

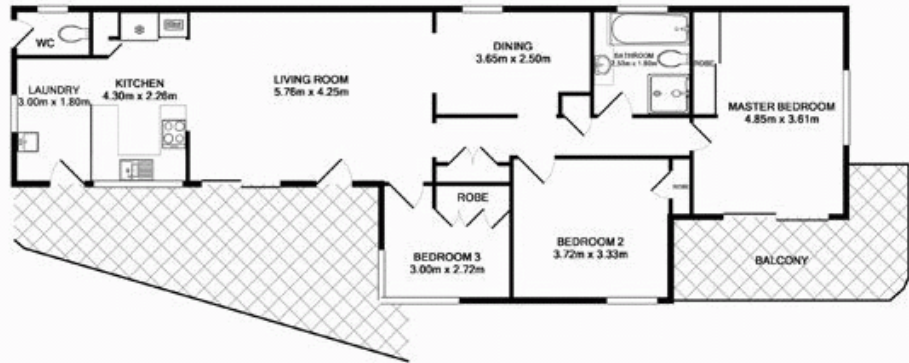

91 Blandford St, Collaroy Plateau

TOTAL APPROX. FLOOR AREA 188.4 SQ.M. (1910 SQ.FT.)
Measurements are approximate. Not to scale. For information purposes only.