

21 Careden Avenue BEACON HILL, NSW

3

1

2

Ideal Modern Family Home

Conveniently designed, this open plan, single level brick home boasts all the functionalities of a family home while filled with stylish features and fixtures. Generous interiors spill to a sunny north facing, under cover balcony, with serene district views, perfect for entertaining all year round. While a large, child & pet friendly rear yard, extends from a generous timber deck facing a sunny N/E, surrounded by neat garden beds. Ideally positioned in a quiet cul-de-sac, right next to a reserve and a choice of schools and Warringah Mall minutes away this home has all the features & the location a family could ask for.

Price:

Offers Over \$840000



Trent McKay

0419 288 867

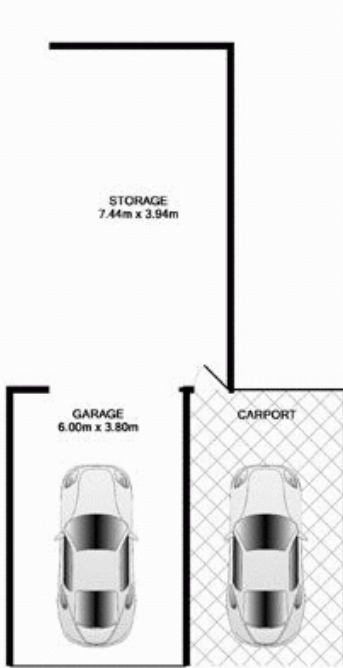

GROUND FLOOR

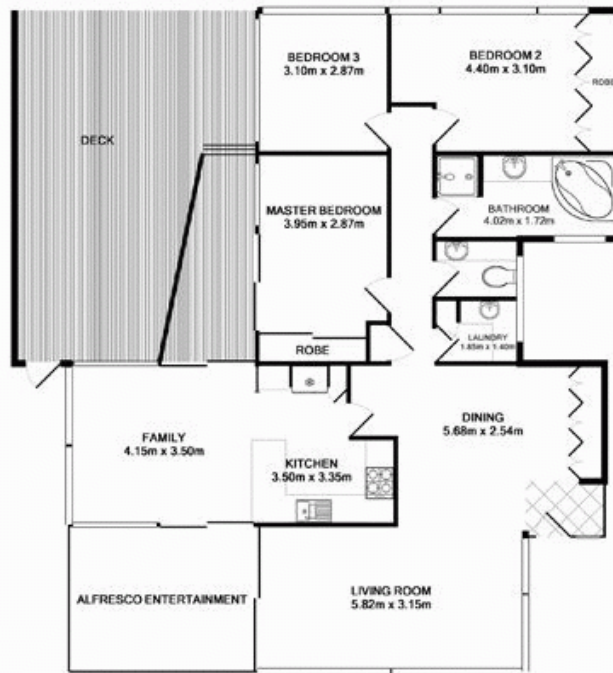

ENTRANCE FLOOR

21 Careden Avenue, Beacon Hill

TOTAL APPROX. FLOOR AREA 217.9 SQ M (2346 SQ FT.)
Measurements are approximate. See to Scale. For Reproduction purposes only.