



71A Claudare Street COLLAROY PLATEAU, NSW

3

2

1

Torrens Title Townhome

Located in one of the Northern beaches most prestigious areas 'Collaroy Plateau, in a quiet, family orientated street, central to a choice of schools, transport, Narrabeen lakes, parks and walking trails is this beautiful Torrens title town home. The lovely blonde brick, render and palm trees create a tropical facade, highlighted by a private, paved patio, surrounded by garden beds and perfect for entertaining or Sunday bbq's.

Price:

Offers Over \$690,000

Stone Mona Vale

02 8030 8549

3 2 1

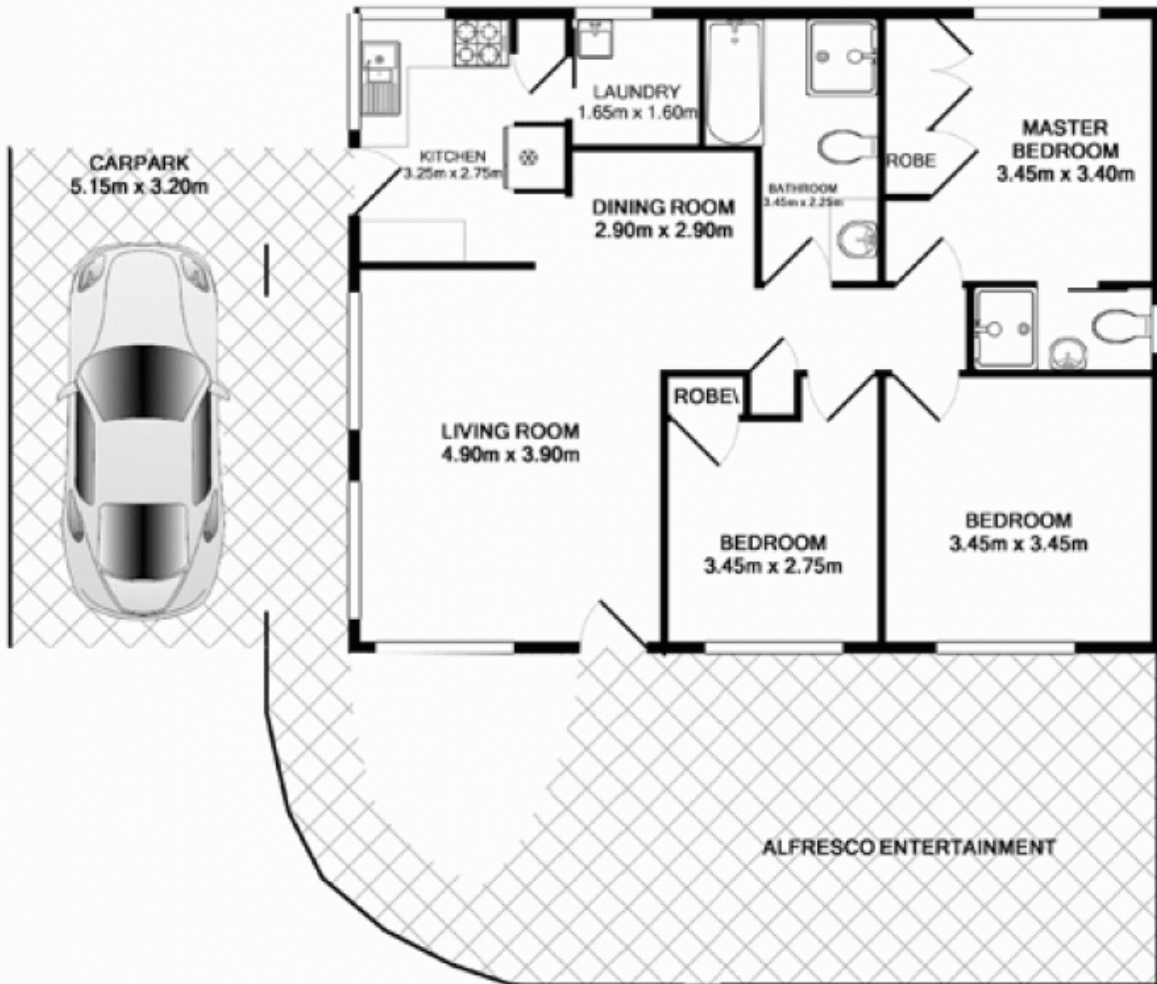

SCALE (METRES)

PLANS SHOWN ONLY INDICATIVE OF LAYOUT. DIMENSIONS ARE APPROXIMATE.

71a Claudare St, Collaroy Plateau

TOTAL APPROX. FLOOR AREA 87.90 M² (940 SQ.FT.)
Measurements are approximate. Not to scale. For illustrative purposes only.