

5/45-49 Campbell Parade MANLY VALE, NSW

2 1 1

Perfect First Home or Sound Investment

Located in a quiet tree lined street, backing onto Passmore reserve, is this sunny two bedroom apartment. Minutes from Manly, a choice of schools, playing fields, city transport and just down the road from Warringah Mall, this quiet location is also extremely central and convenient.

Price: Offers Over \$440,000

Stone Mona Vale

02 8030 8549



2



1



1

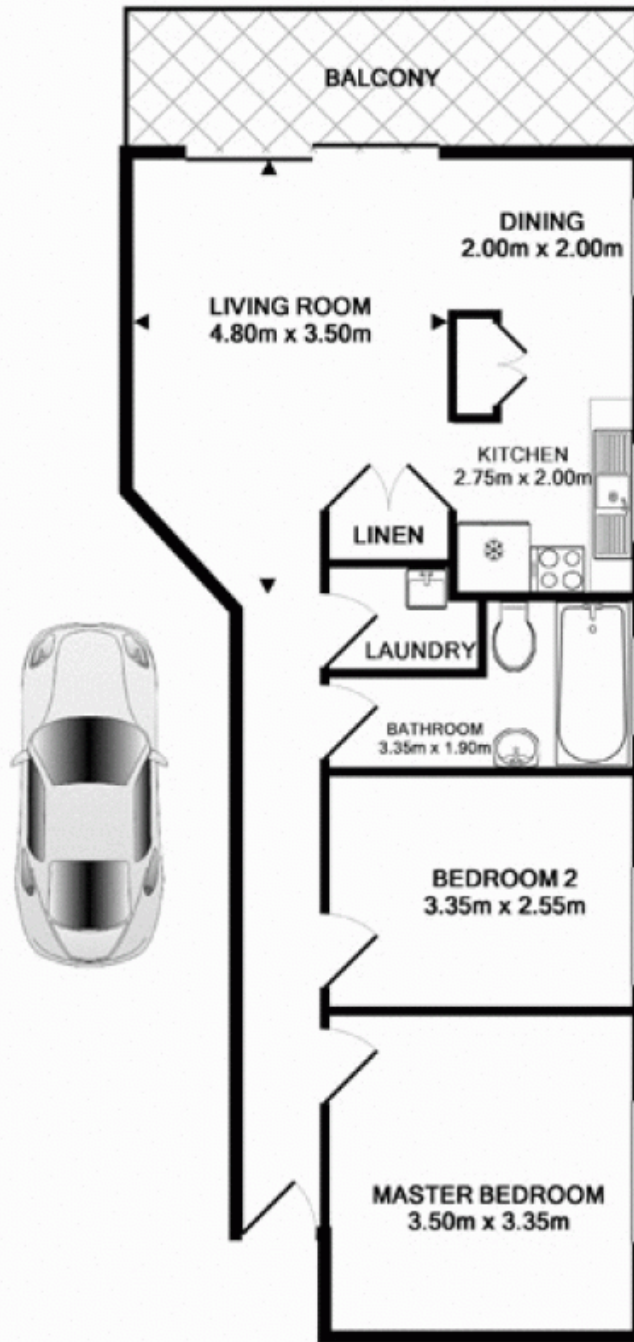

SCALE (METRES)

PLANS SHOWN ONLY INDICATIVE OF LAYOUT. DIMENSIONS ARE APPROXIMATE.

5/45-49 Campbell Parade, Manly Vale

TOTAL APPROX. FLOOR AREA 96.0 SQ.M. (256 SQ.FT.)
Measurements are approximate. Not to scale. For illustrative purposes only.