



8/13-19 Angophora Circuit WARRIEWOOD, NSW



Stylish Modern Living

Ideally located only a short walk to shopping centres, schools, children's playground and transport, this property offers the perfect setting for effortless modern living. Only 3 years young, this contemporary 3 bedroom townhome, located within 'Sea Green on the Park'

is perfect for those looking to downsize or raise a young family without compromising on space and style.

- 3 generous, sunny living areas, with a potential for a 4th bedroom
- Stylish Caesarstone kitchen boasting gas cooking, S/S appliances & large breakfast bench
- Guests W/C downstairs & internal access to a double lock up garage with storage
- Private child and pet friendly courtyard opening from one of the living areas
- King sized master suite boasting walk in robe, north facing balcony & His/Hers ensuite
- Caesarstone family bathroom, living upstairs perfect for a kids play area or media room

Price:

Offers Over \$785,000

Stone Mona Vale

02 8030 8549

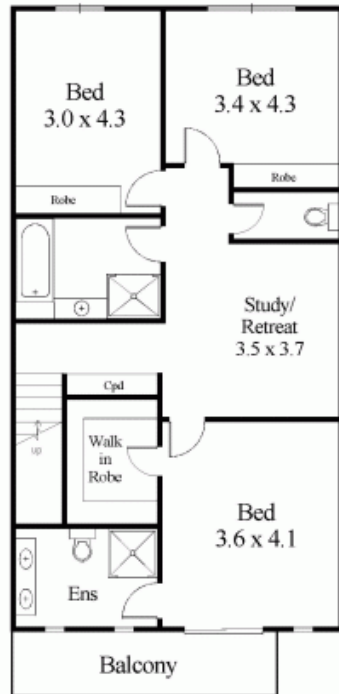

FIRST FLOOR

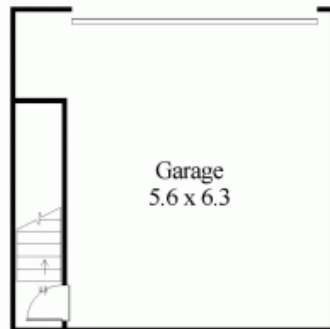

LOWER GROUND



GROUND FLOOR

8/13-19 Angophora Circuit, Warriewood

Disclaimer : K & S Smith-White ABN 84 593 107 368 Trading as NORTHSIDE FLOORPLANS Pymble - Hornsby Tel. 9144 2474; Mob. 0427 442 474
This floor plan serves only as a guide for promotional purposes and should not be scaled or relied upon for any specific detail. No liability will be accepted.