

25 Tyagarah Place CROMER, NSW

4 

2 

1 

### Serenity and Style

Perfectly positioned in a quiet cul-de-sac, adjoining a lush reserve is this beautiful family residence. Surrounded by chic landscaping with a modern yet warm, homely feel.

Price:

Offers Over \$880,000



**Greg Duce**

0409 749 287

4 2 1

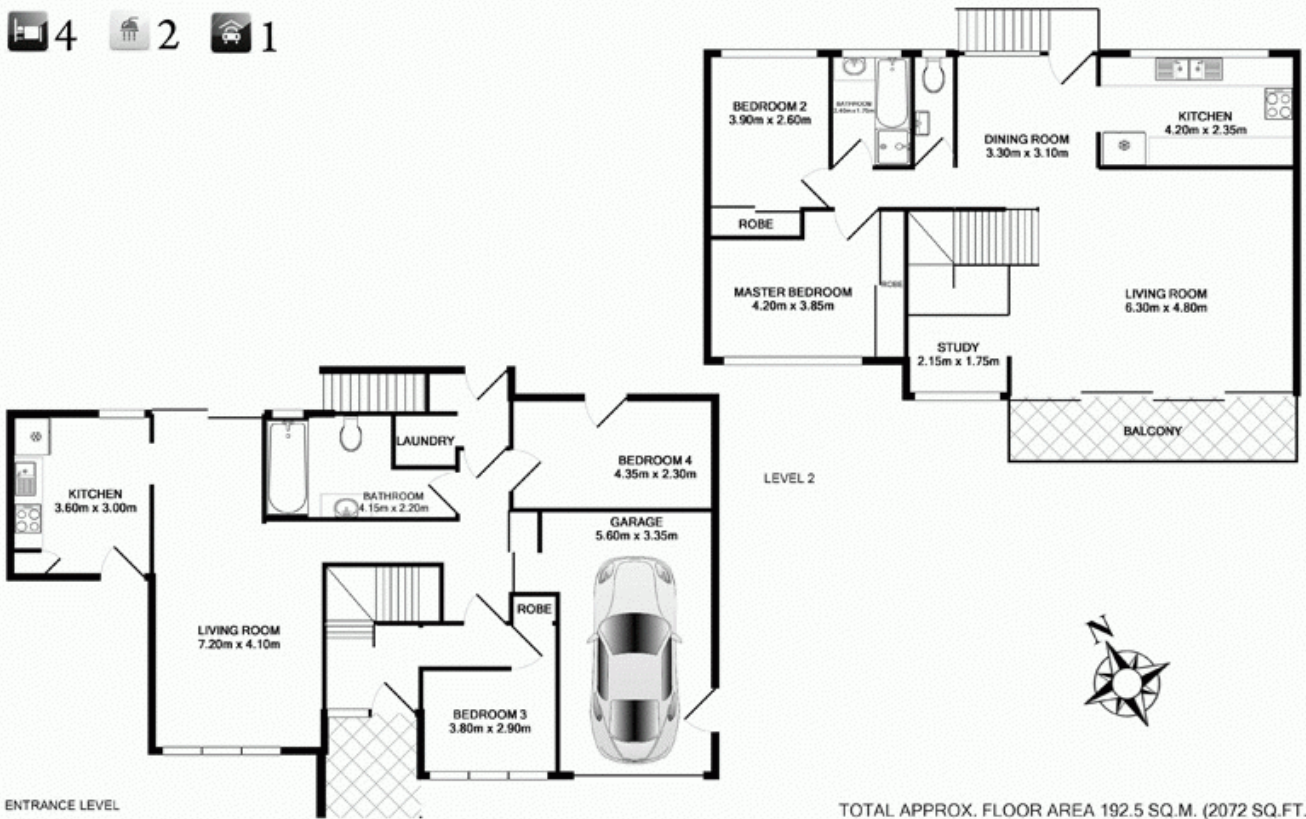

ENTRANCE LEVEL

LEVEL 2

TOTAL APPROX. FLOOR AREA 192.5 SQ.M. (2072 SQ.FT.)  
Measurements are approximate. Not to Scale. For illustrative purposes only.

25 Tyagarah Place, Cromer