



3 Coryule Place WARRIEWOOD, NSW



### Modern & Tranquil Family Home

Perfectly located in a quiet, tree lined cul-de-sac, yet still only minutes walk to shops, transport and local schools is this beautiful family home. Surrounded by low maintenance native garden beds with a stunning view from the living areas over the surrounding district out to the ocean.

Price:

Offers Over \$880000



Trent McKay

0419 288 867

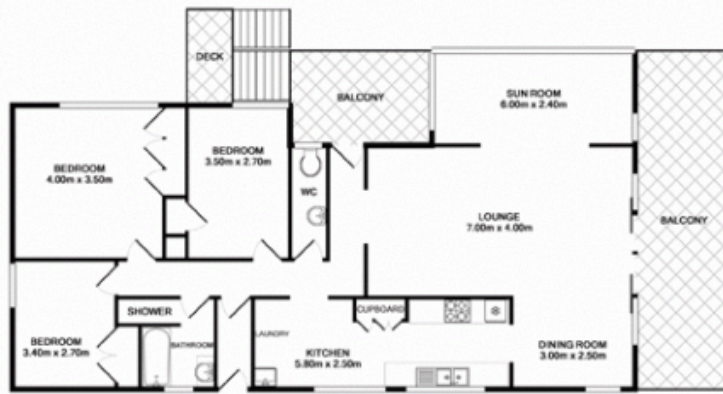

2



3 plus 1 Self Contained Flat



Double Garage

3 Coryule Place, Warriewood

Measurements are approximate. Not to scale. Illustrative purposes only.  
OpenView does not take any responsibility for any information supplied.

Total Approx Floor Area 205.5 sq m