

8 Ronald Avenue GREENWICH, NSW

5 

3 

2 

SOLD - CARLO PALAMARA 0411 644 216

Price:

Offers over \$1,450,000

FOR THE FAMILY

Enjoy indoor-outdoor flow from this inviting extensively renovated modern family residence. There is an abundance of space offering a blend of clean lines and contemporary finishes giving style and comfort for all the family.

Stone Lane Cove

(02) 9427 7466

DISCLAIMER - Maria D'Alessandro
Trading as NORTHSEASIDE FLOORPLANS - Lone Cove
Tel: 0144 3999, Mob: 0404 893 908
This floor plan serves only as a guide for promotional purposes and
should not be relied upon for any specific detail. No liability will be accepted.
INTERNAL FLOOR AREA (approx) 220sq2

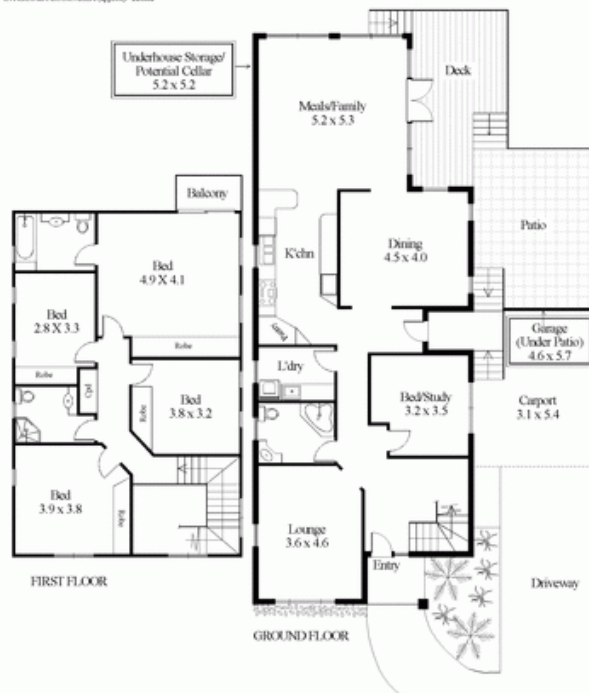

8 Ronald Avenue, Greenwich