

7/42 Cope Street LANE COVE, NSW

3

2

2

SOLD AT AUCTION BY JULIA SIKORA 0410 451 749

Price:

SOLD

Ideal for those who revel in relaxed alfresco entertaining, this charming north east facing townhouse enjoys a uniquely large and level private garden. Set upon 279sqm on title (in total), its fluid and light-filled interiors are equally as impressive providing a tranquil haven with many tasteful modern finishes, and just metres to express city buses and Figtree shops for the ultimate in convenience.

Stone Lane Cove

(02) 9427 7466

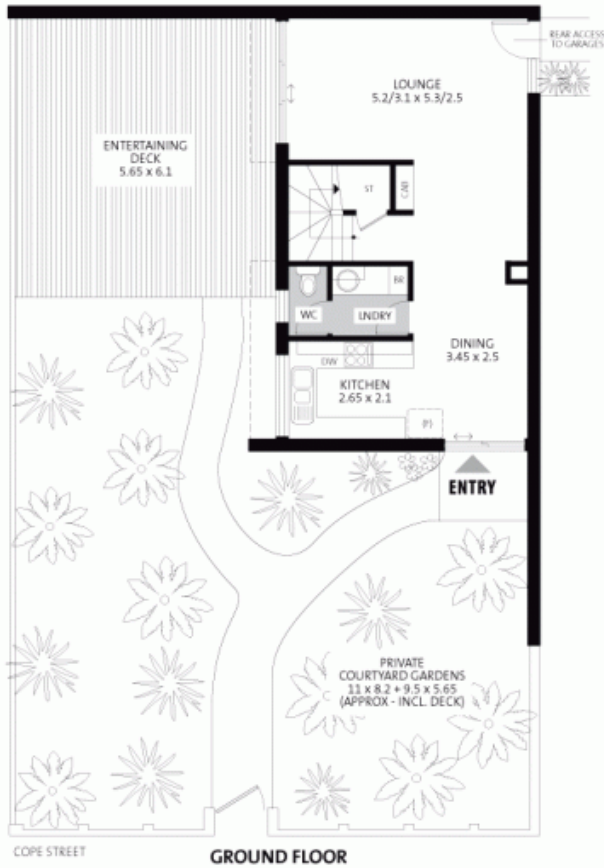

Lane Cove
7/42 Cope Street



FIRST FLOOR



NOT SHOWN:
L/UP DOUBLE GARAGE
(5.5 x 5.4 APPROX)



PLEASE NOTE: All dimensions are approximate, and any boundaries shown are approximate indications only. This floor plan is provided to show the layout for marketing purposes only, and must not be relied upon for any other purpose. No liability will be accepted.