



2 Sofala Avenue RIVERVIEW, NSW



SOLD AT AUCTION - \$1,398,000 BY JOCELYN GREGORY - 0418 230 309

Price: \$1,398,000

Realise the full potential of this quaint and charming two bedroom brick and tile 1930's home on a large, completely level 632m2 site. Renovate and extend to blend original character with modern style and comfort or redevelop to create your ideal home in this coveted Riverview location.

Stone Lane Cove

(02) 9427 7466



REAR LAWN/GARDENS NOT SHOWN



Riverview 2 Sofala Avenue

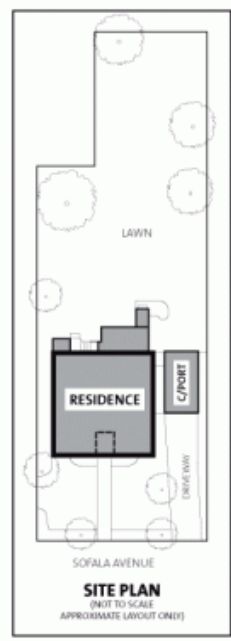

PLEASE NOTE: All dimensions are approximate, and any boundaries shown are approximate indications only. This floor plan is provided to show the layout for marketing purposes only, and must not be relied upon for any other purpose. No liability will be accepted.

FLOOR PLANS - DAVID DIXON (02) 9411 7237