



20 Seville Street LANE COVE, NSW



## SUNSHINE FILLED FAMILY HOME

SOLD BY REBECCA MITCHELL. Discover a world of sun filled level living in this central location, moments to shops, city buses and quality schools. Set back from the street on a 790sqm block, this home has a flexible floor plan flowing to private wraparound gardens. Ideal for the growing family or an attractive investment with options to add value.

- Light filled character home, excellent indoor/outdoor flow to paved living areas
- Generous n-th-facing living spaces, RC/AC in spacious lounge room, lge central dining
- Bedroom wing provides 4 bedrooms, 3 with built-in wardrobes
- Private level gardens with entertaining terraces, lawns, sizeable shed & double carport
- 5 min walk to village, close city buses & parks, in one of Lane Cove's premier streets
- Suitable for a growing family, professional couple or downsizers looking for peaceful, centrally located, low maintenance living and with room to add value

Price:

SOLD by Rebecca Mitchell

**Stone Lane Cove**

(02) 9427 7466

Lane Cove ¥ 20 Seville Street

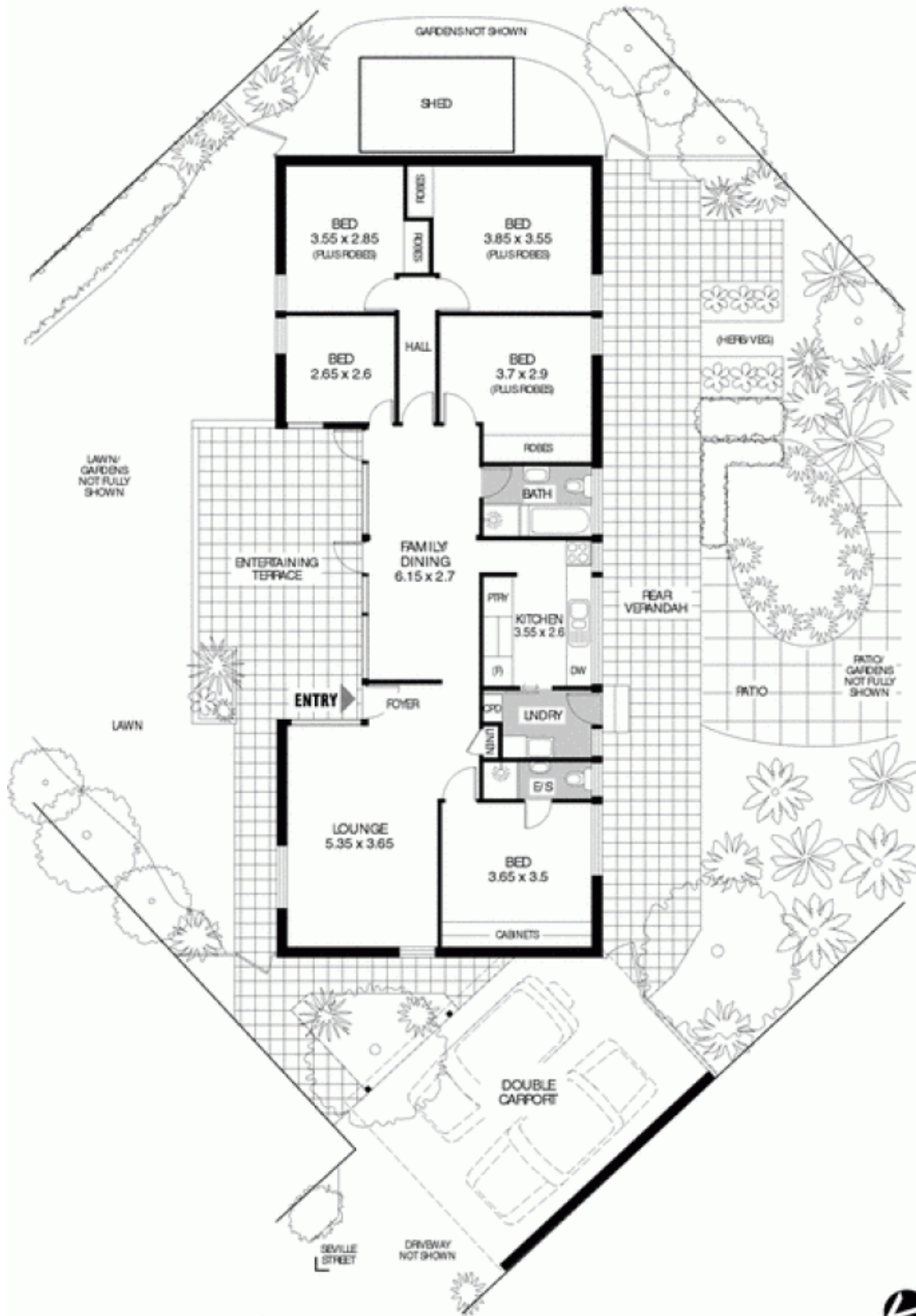

APPROXIMATE SCALE GUIDE (METRES) 0 1 2 3

PLEASE NOTE: All dimensions are approximate, and any boundaries shown are approximate indications only. This floor plan is provided to show the layout for marketing purposes only, and must not be relied upon for any other purpose. No liability will be accepted.

FLOOR PLANS • DAVID DIXON (02) 9411 7237



Hamilton & Co