



541 Mowbray Road LANE COVE, NSW

3

1

1

Family-sized environment with space and appeal

Family buyers will be immediately attracted to the size and space offered by this classically presented residence. Tastefully appointed and immaculately maintained, it sits on a large rear to north landholding with an expansive level yard. This solid brick home is also ideally positioned within walking distance to parks, schools, local cafes and city buses.

- Fresh interiors with high ceilings, polished floors & combined living/dining space.
- North facing backyard with deep level lawn plus workshop with home office.
- Three double bedrooms with ceiling fans and a renovated bathroom with full bathtub.
- Well equipped kitchen with s/steel gas fittings and laundry with extra w/c.
- Moments to Lane Cove village shopping, national parks and easy CBD access.
- Ready now to move in and enjoy with future scope to redesign and enhance.

Price:

Contact Agent

Stone Lane Cove

(02) 9427 7466



GROUND FLOOR

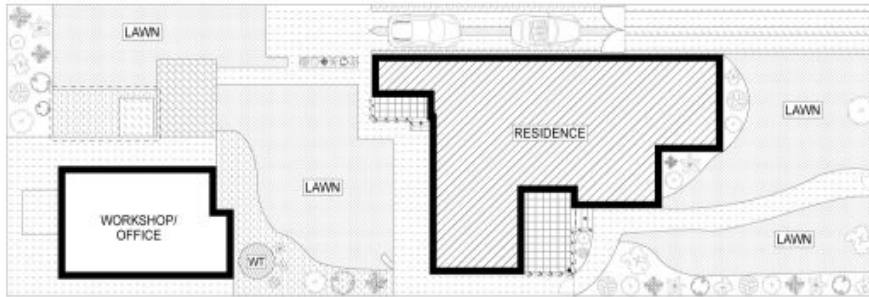

SITE PLAN (NOT TO SCALE)

SCALE (METRES)

PLANS SHOWN ONLY INDICATIVE OF LAYOUT. DIMENSIONS ARE APPROXIMATE.

541 MOWBRAY ROAD, LANE COVE

