



2/10 Whittle Avenue BALGOWLAH, NSW



Large entertaining balcony with leafy views

Set in a block of four, this bright and airy apartment makes an excellent entry point into this coveted Northern Beaches market. A wonderfully convenient position close to schools transport shops parks.

Large entertaining balcony with leafy views

Generous living space dressed in fresh, neutral tones

Two double-sized bedrooms

Tidy, well-presented kitchen with plenty of cupboard space

Total area approximately 75 sqm

Floating wooden floorboards

Carport plus plenty of offstreet parking

Easy access to beaches, Seaforth and Balgowlah shopping

Walk to village shops, cafes, City bus stop at the door

Further scope to update, enhance or recreate interiors

Price:

Over

\$345,000

Stone Manly

02 8962 2200

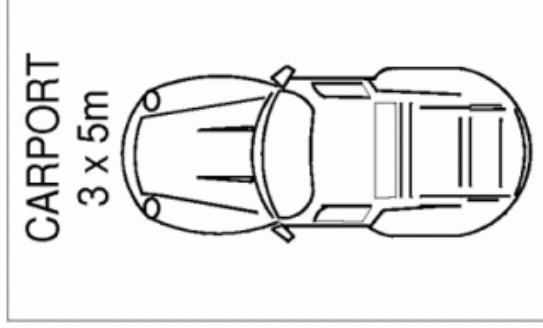
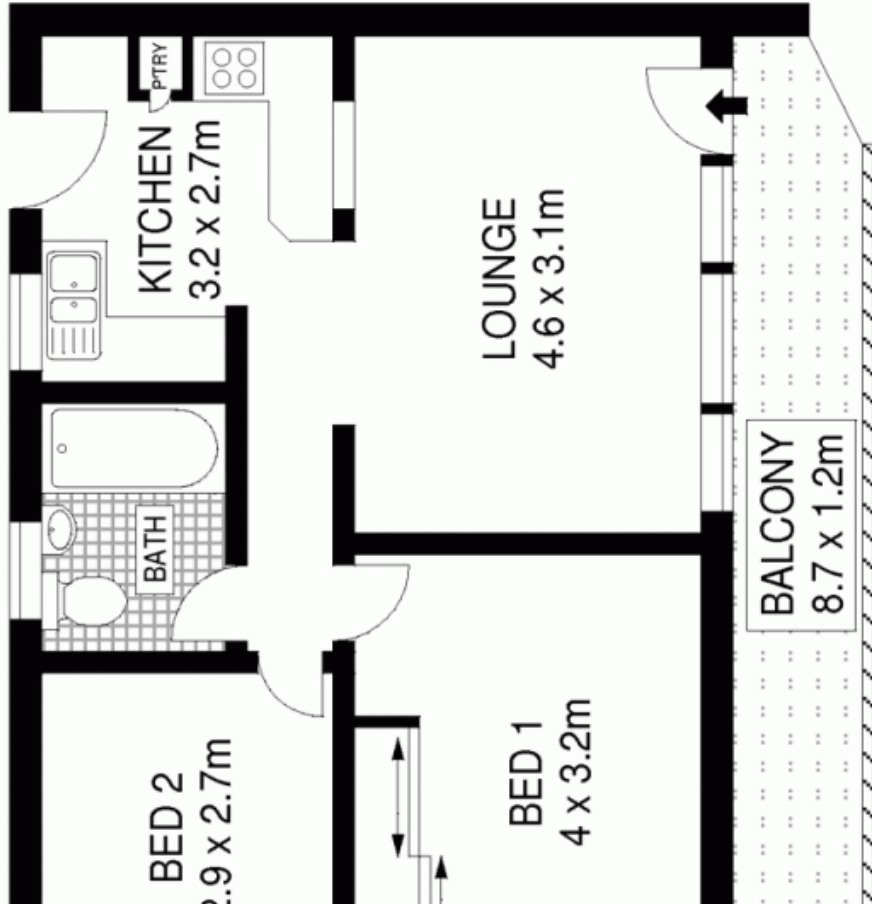

GROUND FLOOR



INT : 53m²
EXT : 25m²