

15A Linkmead Avenue CLONTARF, NSW

4

3

3

Gaze across the water to the upper reaches of Middle Harbour

Take full advantage of inspiring Middle Harbour views on a substantial 1709sqm holding in a coveted cul-de-sac position. Refresh, redesign or rebuild (STCA) and untap vast potential. Unrepeatable opportunity to make your mark in a blue ribbon locale.

Gaze across the water to the upper reaches of Middle Harbour

The property almost extends to a sandy beach at Fisher Bay

Dual level, full brick, open plan and wrapped in glass

Vast living space with views opens to a waterside terrace

Large family room, rumpus room, kitchenette and powder room

Granite kitchen, double bedrooms, built-ins, master ensuite

Sparkling in-ground pool, established child-friendly gardens

Moments from schools, beaches, transport and Harbour Walk

Under house storage, ducted air conditioning, gas heating

Double lock up garage with internal access plus car port

Price:

Over
\$1,800,000

Stone Manly

02 8962 2200



ENTRY LEVEL



LOWER LEVEL

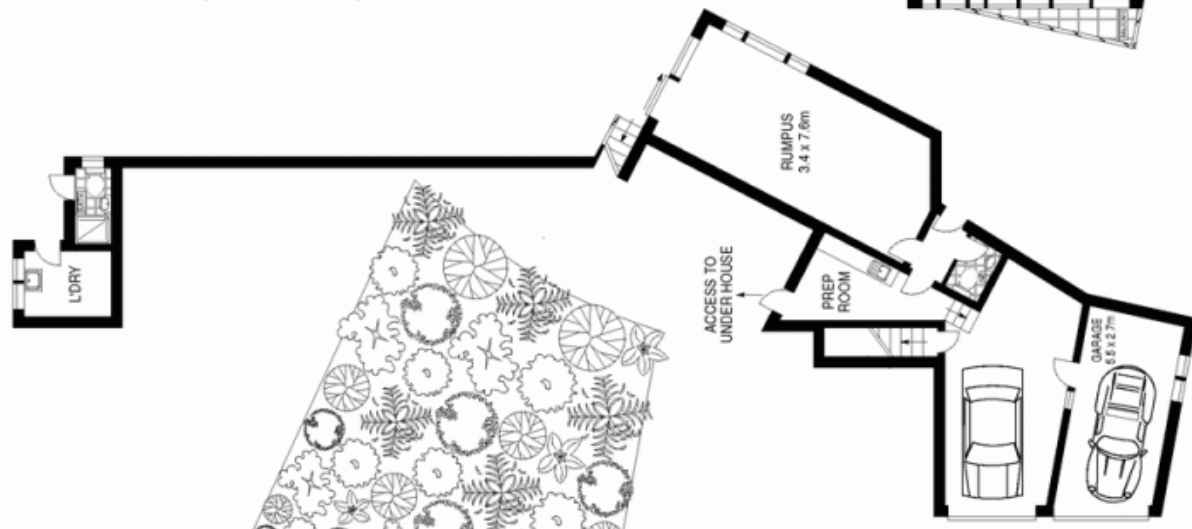

SITE PLAN (NOT TO SCALE)

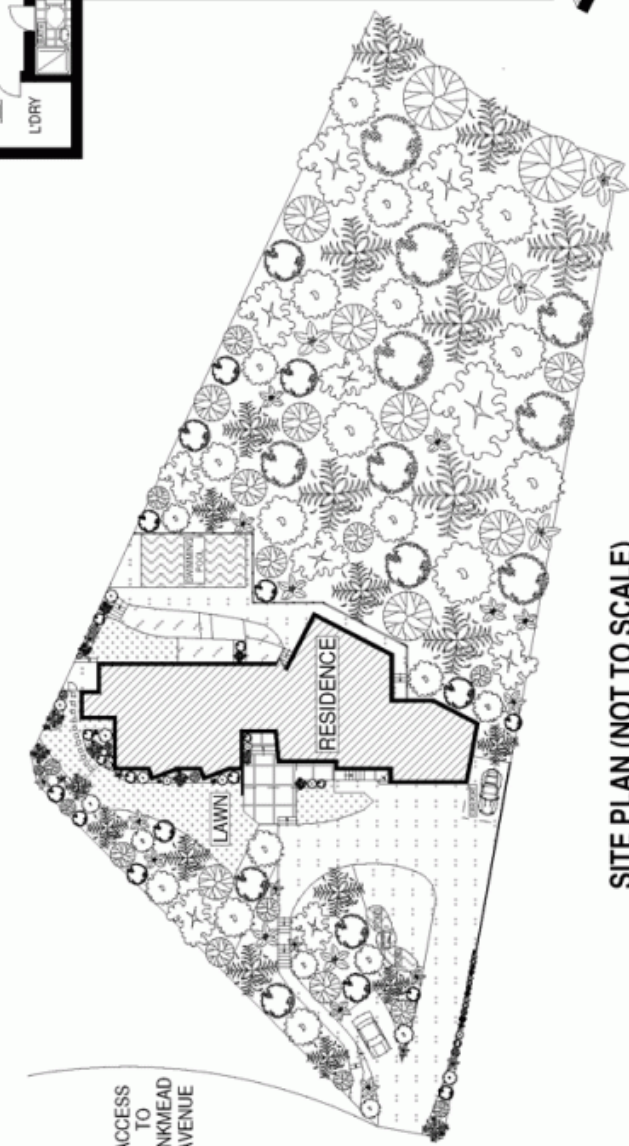

ACCESS TO LINKMEAD AVENUE