



14 Cliff Street MANLY, NSW

4 2 2

### 'Strathmore' is one of the areas landmarks

A residence of timeless distinction and unquestionable style, this impeccably restored Federation family home is peacefully placed on 696sqm of tranquil Balinese-inspired gardens on Manly's coveted Eastern Hill just footsteps from the beach.

'Strathmore' is one of the areas landmarks

- Full brick home with a sandstone base and slate tiled roof
- Elegant timber fretwork, soaring patterned ceilings
- Kauri Pine flooring, leadlight windows, cast iron fireplaces
- Expansive living space opens seamlessly to a covered deck
- Grand formal dining room, large study, giant wine cellar
- Gourmet kitchen with Ironbark benches and Miele appliances
- Elegant bathrooms, double bedrooms, versatile floor plan
- Exquisitely manicured tropical gardens, thatched roof cabana
- Double lock up garage and secure off street parking for more

Price:

Over  
\$3,200,000

**Stone Manly**

02 8962 2200

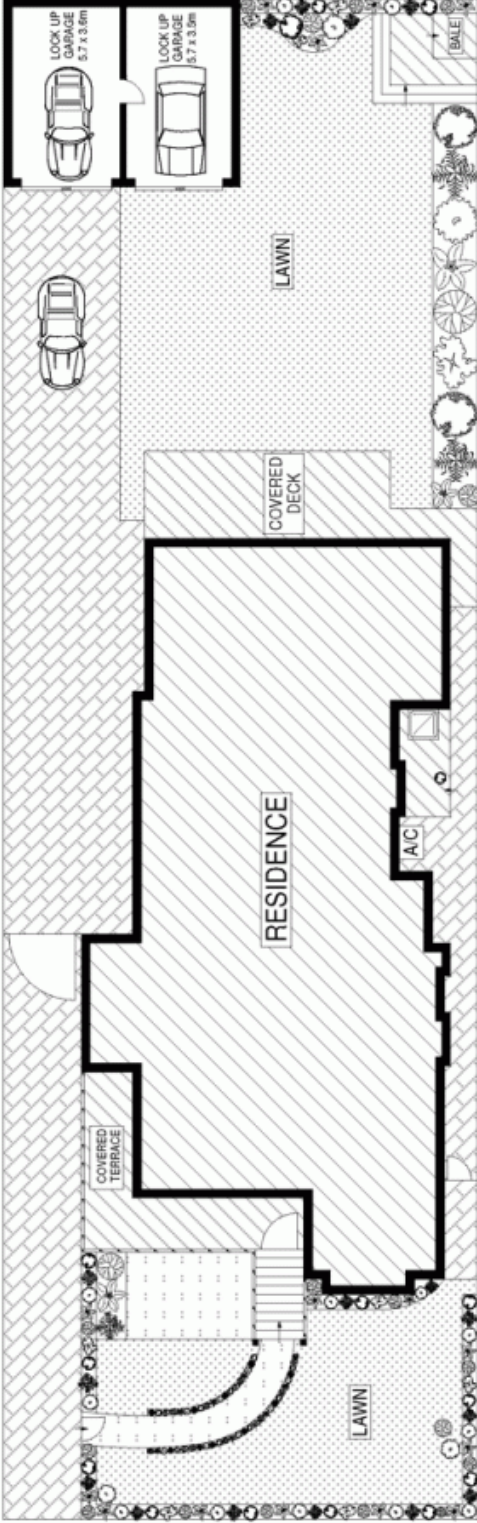

**SITE PLAN (NOT TO SCALE)**

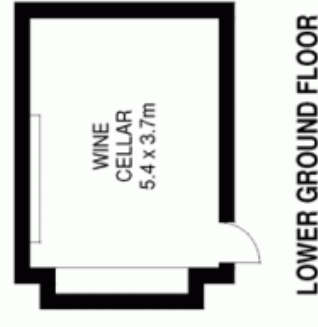
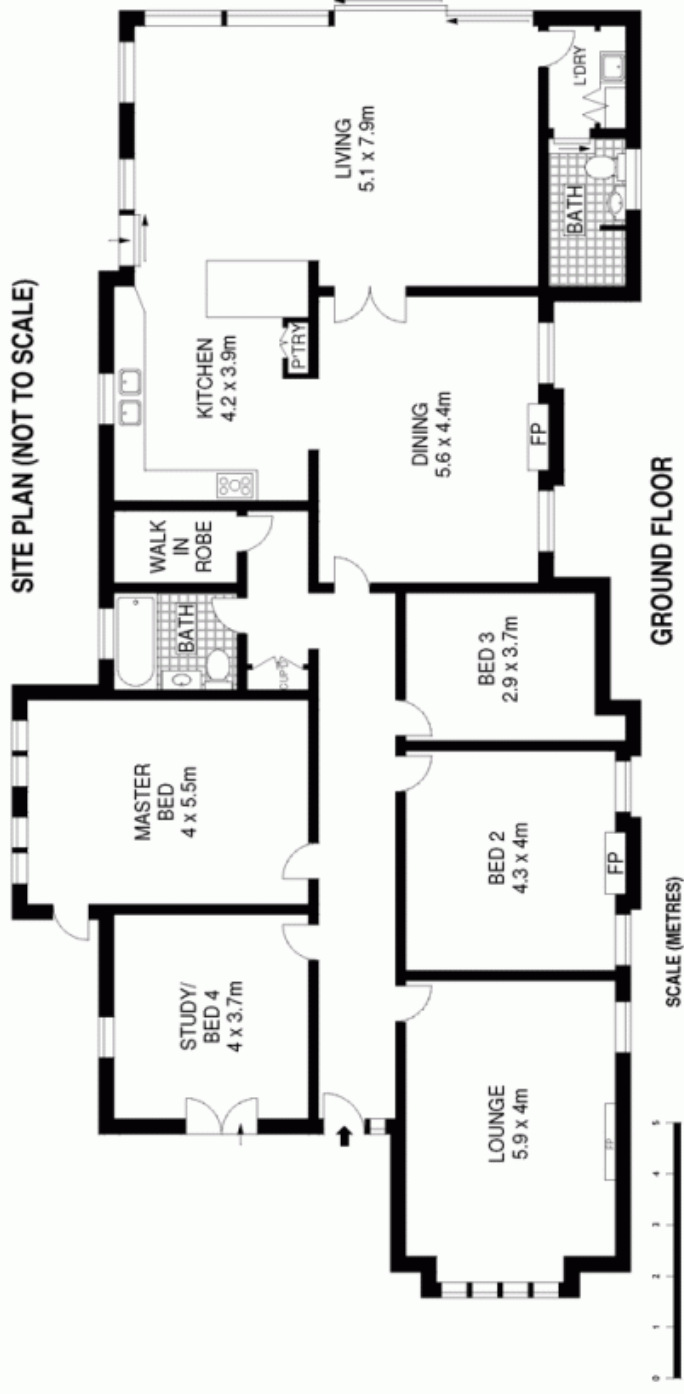

14 CLIFF STREET, MANLY

**McGrath**