



20 Old Pittwater Road BROOKVALE, NSW



Ultra-convenient home, superb outdoor entertaining

Defined by its spacious proportions, versatile floorplan and selection of alfresco areas, this near new two storey residence is a highly appealing family home. It is just seconds from Warringah Mall and city buses with a choice of surf beaches nearby.

- Lower level polished timber floors, seamless in/outdoor flow
- Sizeable open plan living/dining plus formal dining with bar
- Two outdoor terraces at facade, fully enclosed grassed lawn
- Exterior also boasts landscaped gardens and a balcony
- Spacious modern kitchen with all necessary appliances
- Generous bedrooms, two with built-ins, large master walk-in
- Designer bathrooms, two of which are tiled floor-to-ceiling
- Property features video intercoms and alarm security
- Upper level is equipped with ducted air conditioning
- Internal access from double garage with ample shelving

Price:

Price guide over \$800,000

Stone Manly

02 8962 2200

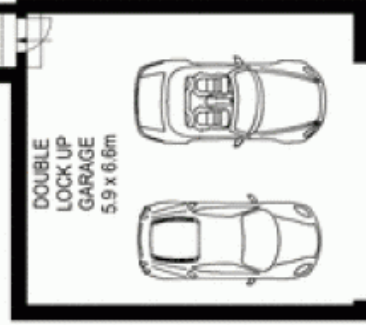
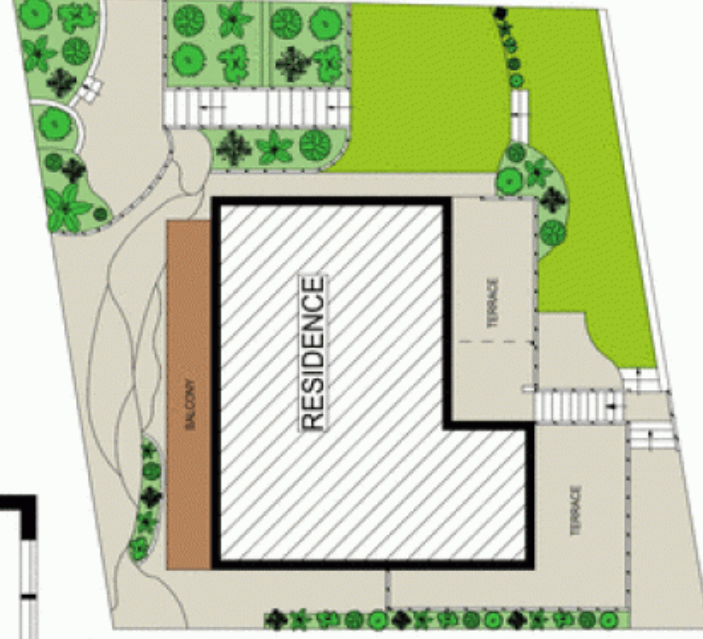

Scale in metres, indicative only. Dimensions are approximates. All information contained herein is gathered from sources we believe to be reliable. However we cannot guarantee its accuracy and interested persons should rely on their own enquiries.

20 Old Pittwater Road, Brookvale

McGrath