

STONE



19 Addison Road MANLY, NSW

4 

4 

6 

An absolute harbourfront architectural masterpiece

The undisputed jewel in Manly's harbourfront crown, this Vince Squillance designed masterpiece is a world-class luxury retreat. Immersed in harbour scenes stretching to Balmoral, Fairlight and the city, it promises a lifestyle simply beyond compare.

The evocative sculptural design spans three stunning levels
Voluminous formal and casual living spaces wrapped in glass
Spectacular indoor/outdoor entertaining to harbour backdrops
Sweeping sunlit stone terraces, landscaped native gardens
Gourmet entertainer's kitchen, home office, imposing entry
Four principal bedrooms, four stunning designer bathrooms
Full brick, wine cellar, pool change rooms, open fireplaces
Spectacular waterfront entertaining area with heated pool
Stroll to beaches, Manly Wharf and cosmopolitan eateries
Six car lock-up garage, entry over a unique koi filled moat

Stone Manly

02 8962 2200

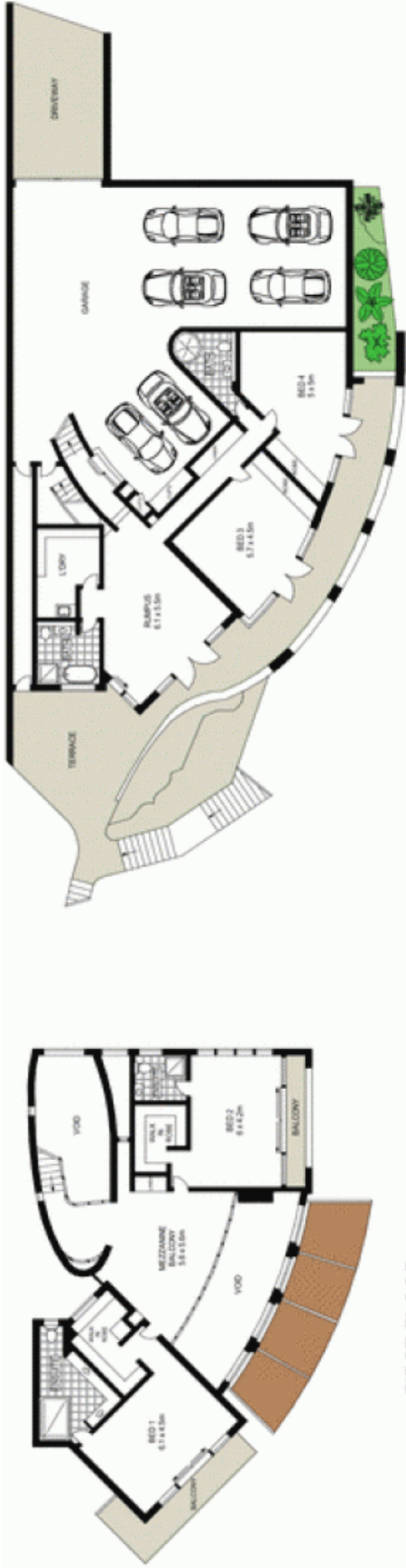

FIRST FLOOR

LOWER GROUND FLOOR



GROUND FLOOR

WATERFRONT LEVEL



BASEMENT



Scale in metres. Indicative only. Dimensions are approximate. All information contained herein is gathered from sources we believe to be reliable. However we cannot guarantee its accuracy and interested persons should rely on their own enquiries.

McGrath

19 Addison Road, Manly