



14 Cecil Street FAIRLIGHT, NSW

2 

1 

Charming Federation semi in a coveted cul-de-sac

A rare and prized offering in one of the area's most highly coveted cul-de-sacs, this exquisite Federation semi is a sumptuous retreat. Restored with integrity and elegantly styled, it opens seamlessly to an enchanting sun soaked northerly garden setting.

- Nestled in a quiet leafy setting metres from Manly's border
- An easy 10 minute stroll to Manly Beach, wharf and eateries
- Wide sweeping light filled open plan living and dining space
- Bi-fold doors open to a covered northerly entertainers' deck
- Level rear lawn framed by manicured hedges
- Deluxe open plan CaesarStone kitchen with European appliances
- Generous bedrooms with built-ins, stylish modern bathroom
- Front porch with timber fretwork behind a white picket fence

Price:

Price guide over \$1,000,000

Stone Manly

02 8962 2200



SITE PLAN (NOT TO SCALE)

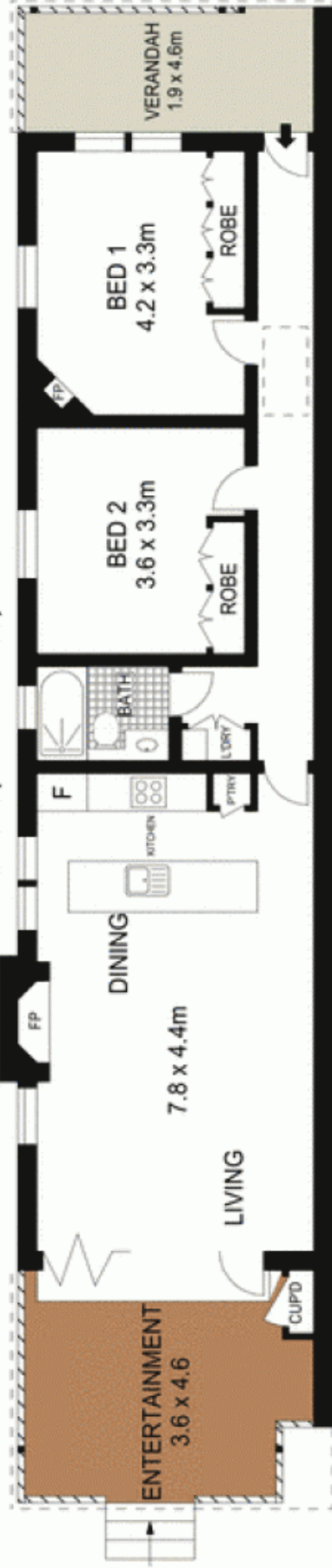

GROUND FLOOR



ATTIC (ACCESS VIA LADDER)



Scale in metres. Indicative only. Dimensions are approximate. All information contained herein is gathered from sources we believe to be reliable. However we cannot guarantee its accuracy and interested persons should rely on their own enquiries.