



20 Smith Street MANLY, NSW

3 

1 

1 

Lifestyle haven for professionals or downsizers

An extensive architectural rebuild and cutting edge professional interior design has newly transformed this semi into a contemporary beachside sanctuary. It's set in a sought-after street just a few minutes walk to the beach, shops, ferries and city buses.

- Showcasing the best in design by 'Creative Space Interiors'
- Bright open plan living areas with soaring high ceilings
- Bi-fold doors open to entertaining courtyard/parking
- Rear lane access to car space complete with auto door
- Gourmet CaesarStone/gas kitchen with European appliances
- Three bedrooms featuring soft close built-in wardrobes
- Sleek bathroom with operable skylight and Zucchetti tapware
- Hallway floor lighting, surround sound cabling, beach shower

Price:

Price guide over \$1,250,000



Adam Moore

0428 319 096

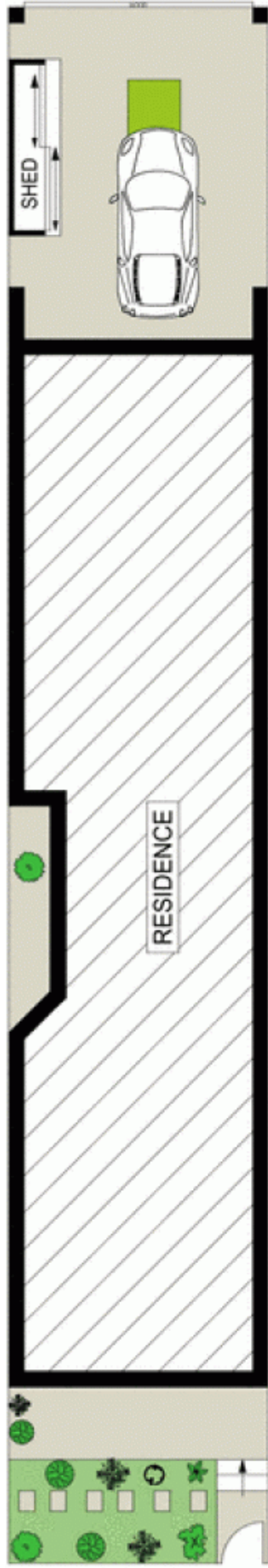

SITE PLAN (NOT TO SCALE)

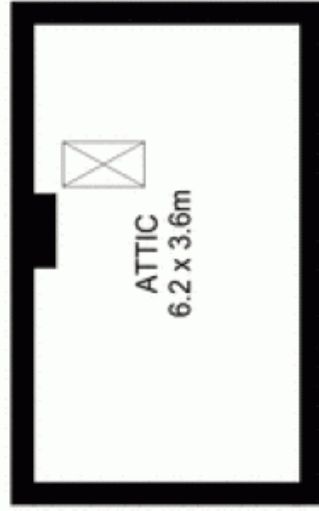

ATTIC

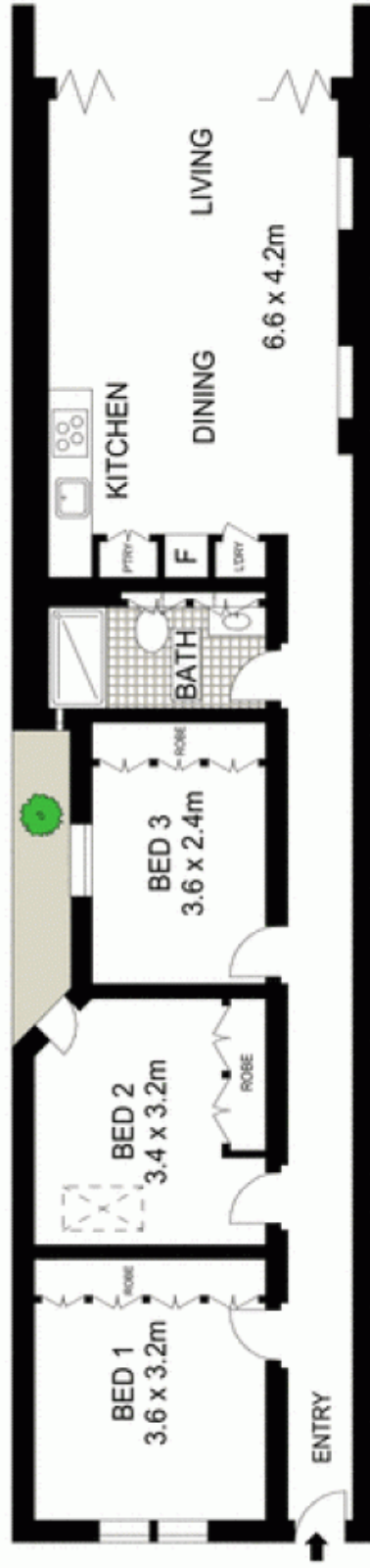

Scale in metres. Indicative only. Dimensions are approximate. All information contained herein is gathered from sources we believe to be reliable. However we cannot guarantee its accuracy and interested persons should rely on their own enquiries.

20 Smith Street, Manly

McGrath