



34/6 Pacific Street MANLY, NSW 3 2 2

Spacious 247sqm apartment in a desirable location

Enjoying a prized top floor position in a highly sought-after security building, this penthouse style apartment is defined by its generous interiors and oversized sundrenched balcony. Immaculately presented throughout, it is just footsteps to the beach.

- Pristine interiors spanning 220sqm of light filled living
- Stylish lounge and defined dining open to the balcony
- Fully equipped timber gas kitchen with European appliances
- Double sized bedrooms all fitted with built-in wardrobes
- Main bedroom with a full sized ensuite and spa bath
- Full sized bathroom with marble vanity, separate powder room
- Air conditioning and heating throughout, quality carpet
- A great investment opportunity in a tightly-held building

Price: Price guide over \$1,500,000



Candice Cattell

0417 311 777

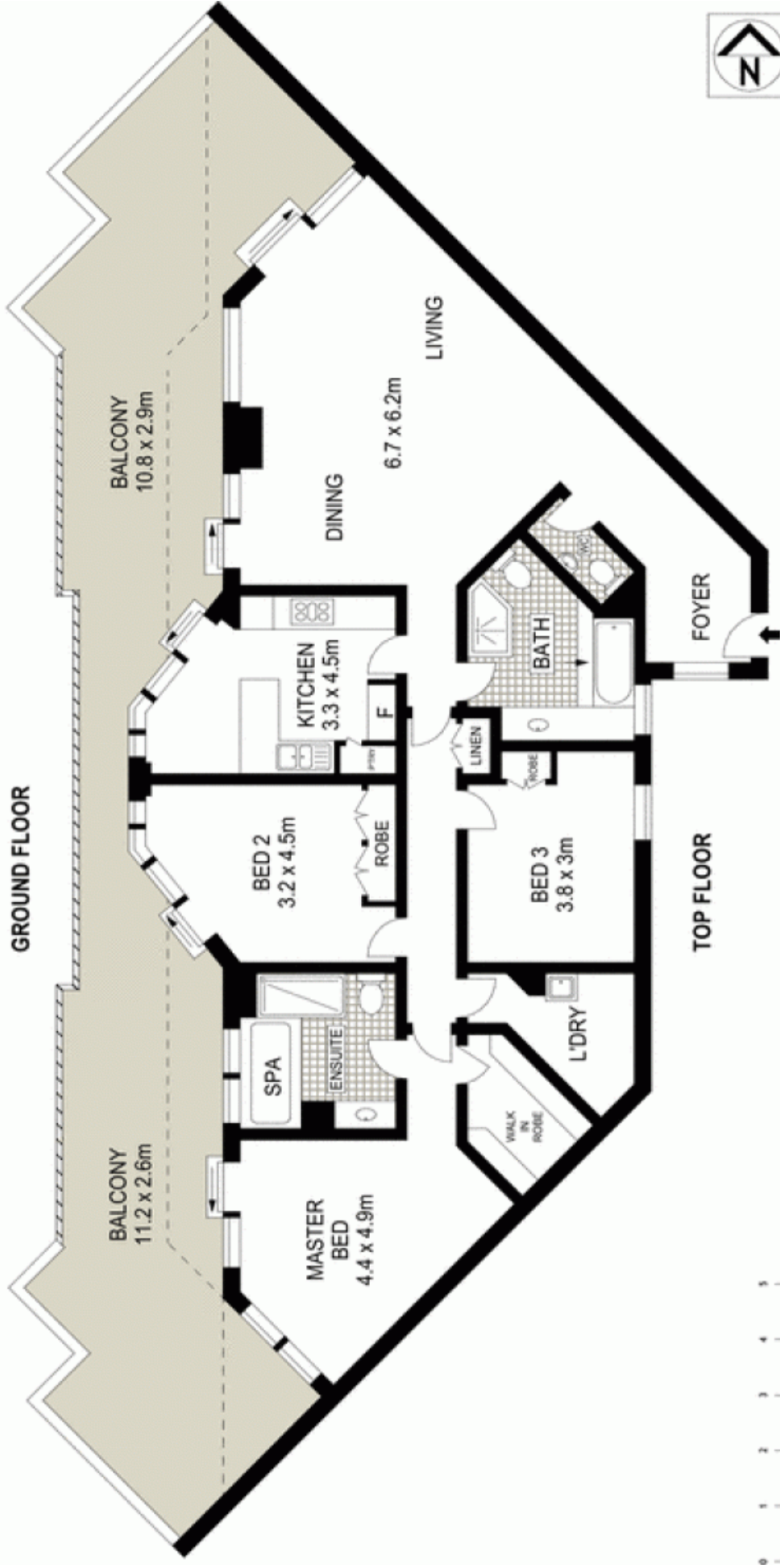
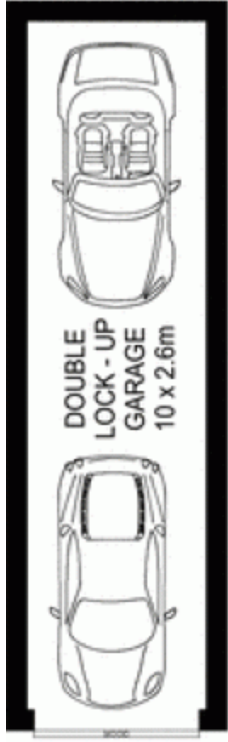

Scale in metres. Indicative only. Dimensions are approximate. All information contained herein is gathered from sources we believe to be reliable. However we cannot guarantee its accuracy and interested persons should rely on their own enquiries.



McGrath

34/6 Pacific Street, Manly