



28 Seaforth Crescent SEAFORTH, NSW



'Seaforth Bluff' home with stunning water views

Elevated on tightly-held 'Seaforth Bluff', this original home enjoys scenic Middle Harbour views from almost every room. It's exceptionally accommodating as is and presents an opportunity to capitalise on DA approved plans for a luxurious new residence.

- Views encompassing the North Sydney and city skylines
- Two generous house wide balconies overlooking the water
- Level front and rear gardens plus an above ground spa
- Superb natural light, mint condition floorboards throughout
- Parents' retreat with own sitting room or study and ensuite
- Sunny, air conditioned living/dining area and neat kitchen
- Split full bathroom, enclosed verandah with laundry at rear
- Automatic double lock-up garage with secure storage/cellar

Price:

Price guide over \$2,200,000

Stone Real Estate

02 9949 2822

Seaforth

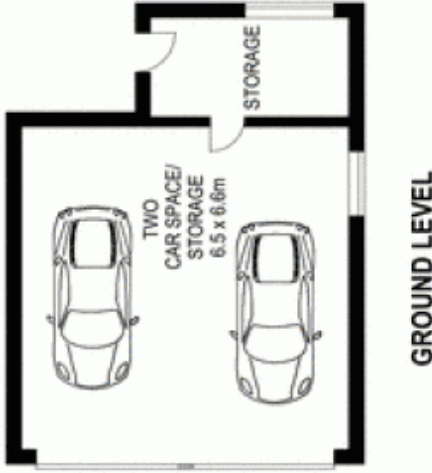
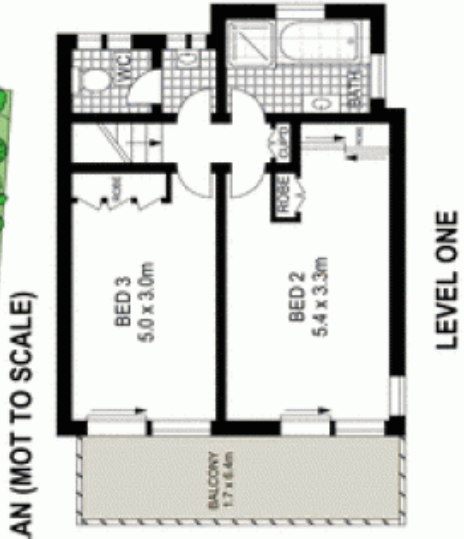
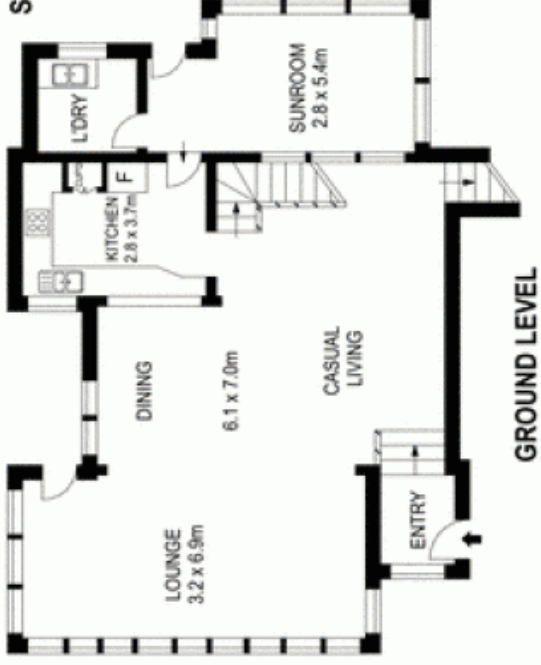

Scale in metres. Indicative only. Dimensions are approximates. All information contained herein is gathered from sources we believe to be reliable. However we cannot guarantee its accuracy and interested persons should rely on their own enquiries.



28 Seaforth Crescent, Seaforth

McGrath