



105/61 Osborne Road Manly, NSW 1 1 1

Perfect Investment on the Eastern Hill

Situated in a quiet block at the cul-de-sac end of Osborne Road on Manly's sought-after Eastern Hill, this first floor 'Osborne Court' apartment is the perfect investment. It features a separate entry at the very rear of the building, along with a bright airy aspect and views through the trees towards the water.

Price: \$710,000



Candice Cattell

0417 311 777

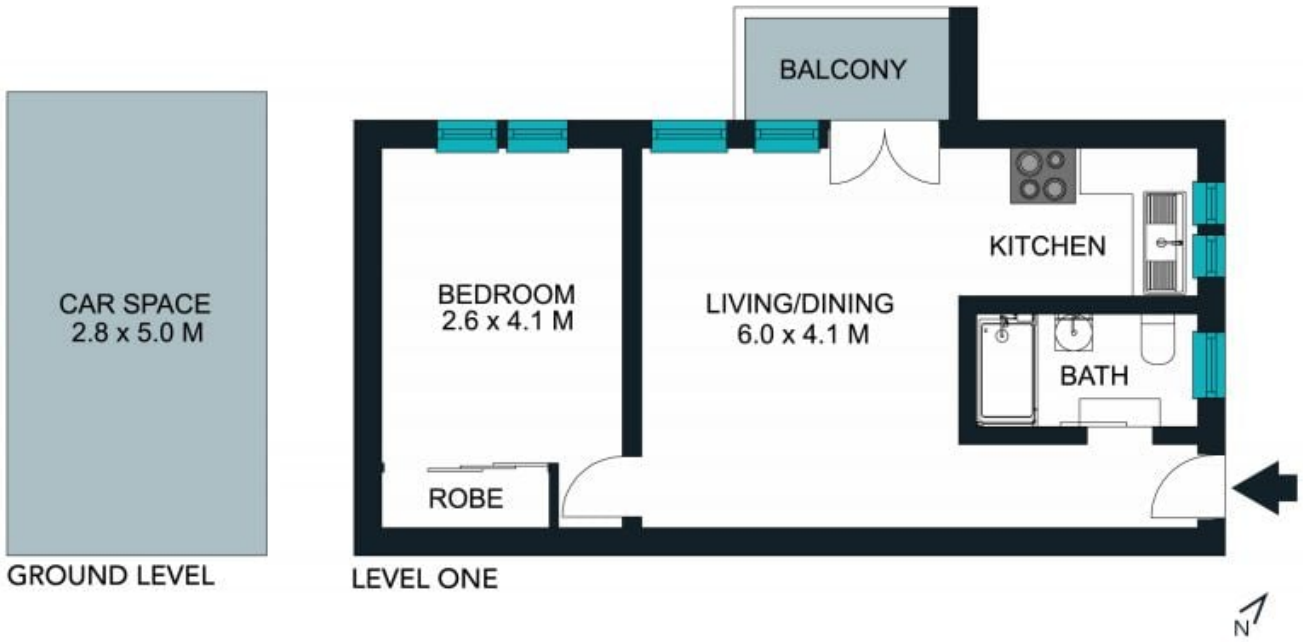

The floor plan is not to scale; measurements are indicative and in metres. Exterior elements are not in position. Plans should not be relied on. Interested parties should make and rely on their own enquiries.

105/61 Osborne Road, Manly
stonerealestate.com.au

Produced by DIAKRIT



GROUND LEVEL

LEVEL ONE



The floor plan is not to scale; measurements are indicative and in metres. All features included in this 3D plan are for inspiration purposes only. This is not an exact replica of the property or the position of exterior elements. Plans should not be relied on. Interested parties should make and rely on their own enquiries.

105/61 Osborne Road, Manly
stonerealestate.com.au

Produced by DIAKRIT