



28 Kennedy Place Bayview, NSW



One of Sydney's most enchanting escapes

Postcard-perfect views over Pittwater's yacht-jewelled bays to Ku-ring-gai Chase National Park take centre stage from this luxurious resort-like sanctuary. Showcasing sweeping glass wrapped living spaces and extensive waterside decks drenched in northerly sunlight, it rests at the end of an exclusive cul-de-sac on private easycare gardens adjoining natural bushland reserve.

- Commanding views over Pittwater to Barrenjoey lighthouse at Palm Beach
- Bright open living and dining space with cathedral ceiling and cosy fireplace
- Glass sliders open to a wide sunlit verandah with covered entertaining area
- Family room, 4th bedroom/home office flows to lower deck
- Poolside retreat opens to pool-deck
- CaesarStone kitchen with dishwasher
- Main bedroom has ensuite, sleek bathrooms
- Set on 771sqm of easycare tropical landscaped gardens with a sparkling pool

Price:

2200000



Phillip Wright

0488 586 860



Louise Ashdown

0414 764 108

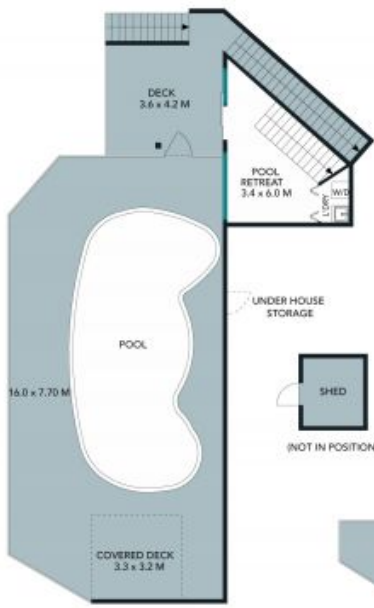

LOWER LEVEL



MIDDLE LEVEL



ENTRY LEVEL



TOTAL LAND AREA : 771 SQM
 TOTAL LIVING AREA : 214 SQM

The site plan and floor plan are not to scale, measurements are indicative and in metres. Bashes and trees are placed for illustration purposes. Plans should not be relied on. Interested parties should make and rely on their own enquiries.



28 Kennedy Place, Bayview
 stonerealestate.com.au

Produced by DIAKRIT



The floor plan is not to scale, measurements are indicative and in metres. All features included in this 3D plan are for inspiration purposes only. This is not an exact replica of the property or the position of exterior elements. Plans should not be relied on. Interested parties should make and rely on their own enquiries.

28 Kennedy Place, Bayview
 stonerealestate.com.au

Produced by DIAKRIT