



18/26 The Crescent Manly, NSW 3 1 1

Spacious apartment with stunning harbour views

Sweeping harbour panorama takes centre stage from this art deco apartment, located directly across the road from grassy harbourfront reserve, Fairlight walk and secluded swimming at Delwood Beach. It is only a few minutes stroll to Manly Wharf, harbourside beaches, thriving eateries and world-famous Manly Beach.

Price: \$1050 per week

Bond: \$4,200

Available Date: 04/08/2018



Georgia Prior

02 8962 2200

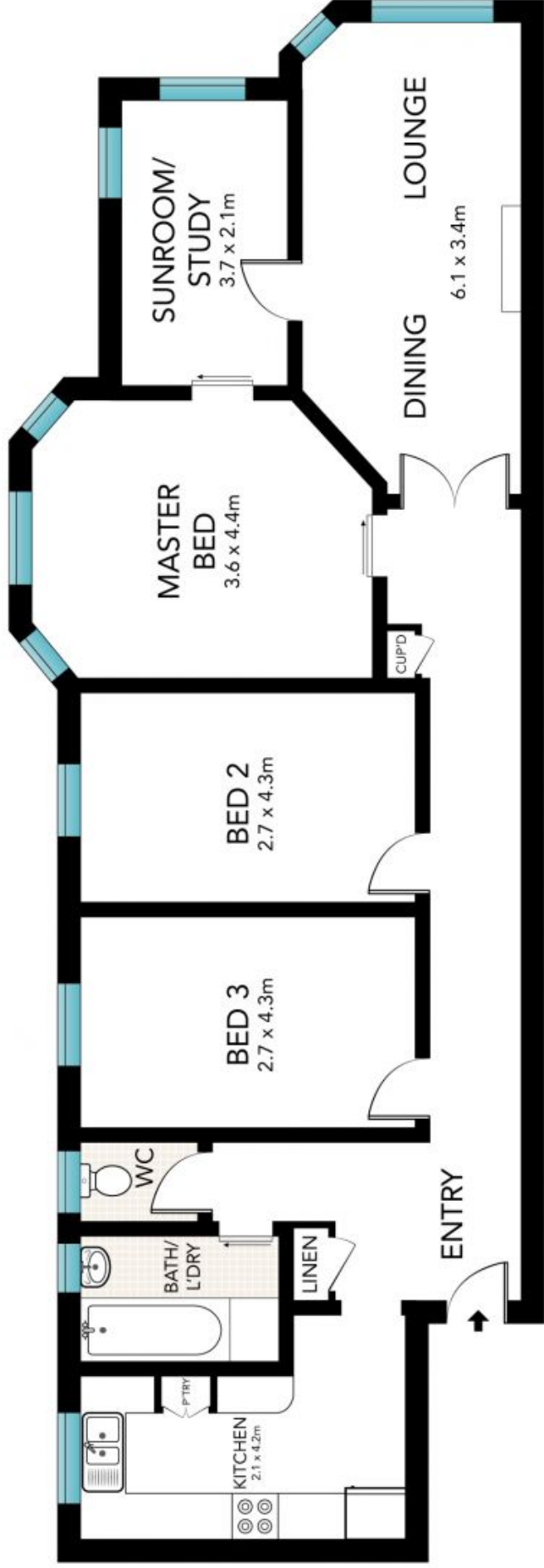

TOP FLOOR

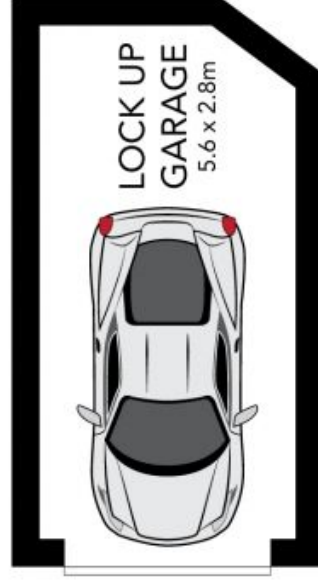

SCALE (METRES)

All the information provided has been collected from reliable sources but cannot be guaranteed for accuracy. Interested persons should rely on their own enquiries. All dimensions are approximate and indicative only.



18/26 THE CRESCENT, MANLY