



39/2A Campbell Parade Manly Vale, NSW



Luxe north facing apartment in exclusive 'Augusta'

A haven of enviable peace and privacy, this sophisticated garden apartment enjoys a sundrenched rear north position in Manly Vale's most desirable building, with direct access to Warringah Golf Course and closeup fairway views. It offers stylish low maintenance living in serene green surrounds with bright, airy interiors and alfresco entertaining, moments to all conveniences.

- Prestigious security complex neighbouring Passmore Reserve & the golf course
- Entrance shared by only three others and well-secluded back from Campbell Pde
- Living/dining seamlessly extends onto a north garden terrace for entertaining
- Integrated CaesarStone kitchen features all-Miele appliances and gas cooking
- Double sized bedrooms both fitted with built-ins plus an ensuite to the master
- Full main bathroom, internal laundry, auto double garage in basement car park
- Entry intercom, alarm system and fully ducted reverse cycle air conditioning
- Handy to shops, cafes, B-Line city buses, schools, Warringah Mall and beaches



Chris Elliott

0410 416 066



Chris Elliott

0410 416 066

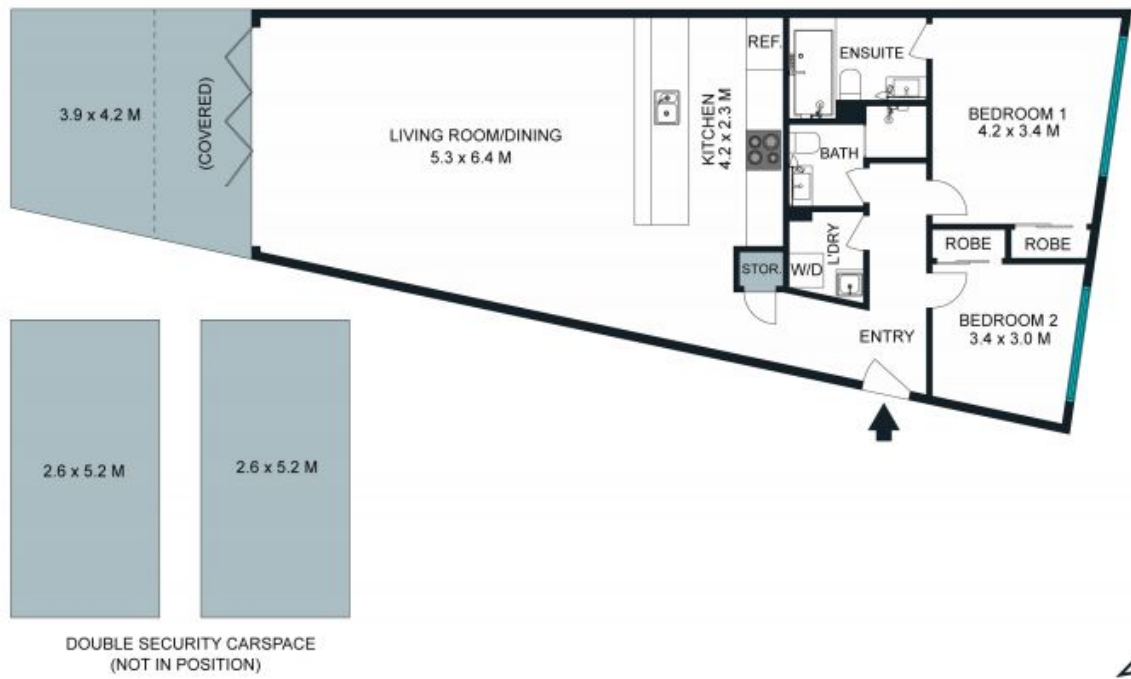

The floor plan is not to scale; measurements are indicative and in metres. Exterior elements are not in position. Plans should not be relied on. Interested parties should make and rely on their own enquiries.

39/2a Campbell Parade, Manly Vale
 stonerealestate.com.au

Produced by DIAKRIT



The floor plan is not to scale; measurements are indicative and in metres. All features included in this 3D plan are for inspiration purposes only. This is not an exact replica of the property or the position of exterior elements. Plans should not be relied on. Interested parties should make and rely on their own enquiries.

39/2a Campbell Parade, Manly Vale
stonerealestate.com.au

Produced by DIAKRIT