



48 Kempbridge Avenue Seaforth, NSW

3 2 2

Charm and character in a cosmopolitan location

Occupying a coveted cul-de-sac position, this elegant single level 1930's bungalow offers space, light and charm in abundance. Flowing interiors spill out to a large sun-filled terrace and level garden, ideal for kids and entertaining, while the neighbourhood has a great community feel. Near Seaforth Public School and moments to the village and city buses, this is the dream for young families and downsizers alike.

Price: Price Not Disclosed



Maria Cassarino

0411 818 093



Julian Rowe

0412 544 448

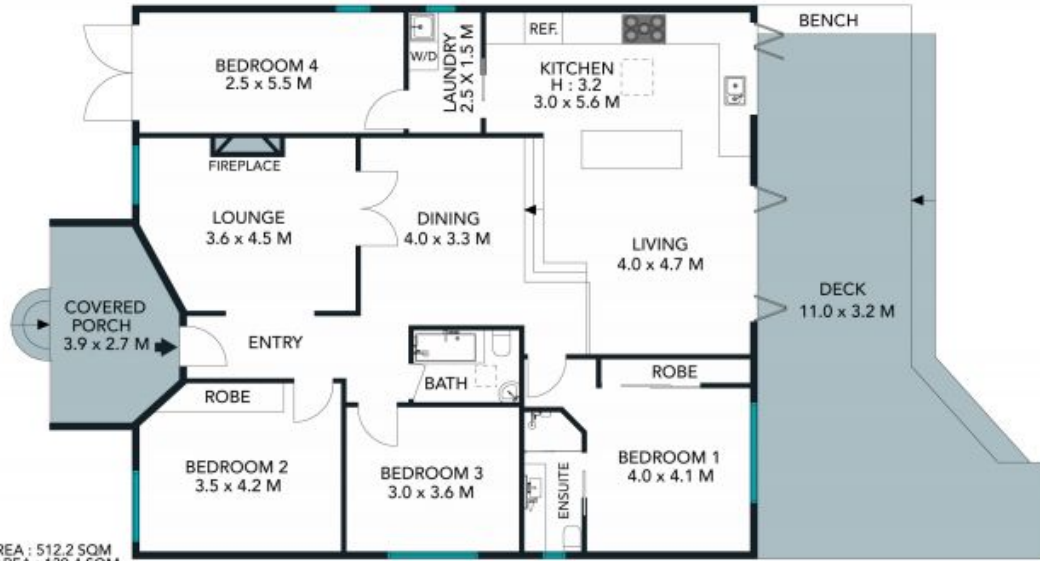

TOTAL LAND AREA : 512.2 SQM
 TOTAL LIVING AREA : 139.4 SQM

The site plan and floor plan are not to scale; measurements are indicative and in metres. Bushes and trees are placed for illustration purposes. Plans should not be relied on. Interested parties should make and rely on their own enquiries.



48 Kempbridge Avenue, Seaforth
 stonerealestate.com.au

Produced by DIAKRIT



TOTAL LAND AREA : 512.2 SQM
TOTAL LIVING AREA : 139.4 SQM

The floor plan is not to scale; measurements are indicative and in metres. All features included in this 3D plan are for inspiration purposes only. This is not an exact replica of the property or the position of exterior elements. Plans should not be relied on. Interested parties should make and rely on their own enquiries.

48 Kempbridge Avenue, Seaforth
stonerealestate.com.au



Produced by DIAKRIT