



20 Lamerton Drive Figtree, NSW

3 

2 

1 

Spacious family home in quiet, convenient location

Located in one of Figtree's most desirable streets, this quality brick and tile home is immediately comfortable and offers a young family the opportunity to enjoy as is or update to make their own. Impeccably maintained, this family home enjoys a peaceful setting yet conveniently located close to excellent schools, village shops and easy access to Wollongong CBD.

Price:

Price Guide \$700,000 - \$770,000



Matthew Kasbarian

0432 521 051



Paul Piacentin

0411 754 884



TOTAL LAND AREA : 556 SQM
 TOTAL LIVING AREA : 142 SQM

The site plan and floor plan are not to scale; measurements are indicative and in metres. Bushes and trees are placed for illustration purposes. Plans should not be relied on. Interested parties should make and rely on their own enquiries.

20 Lamerton Drive, Figtree
 stonerealestate.com.au

Produced by DIAKRIT



1ST FLOOR

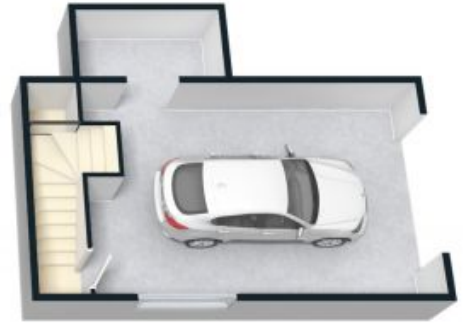

GROUND FLOOR



The floor plan is not to scale; measurements are indicative and in metres. All features included in this 3D plan are for inspiration purposes only. This is not an exact replica of the property or the position of exterior elements. Plans should not be relied on. Interested parties should make and rely on their own enquiries.

20 Lamerton Drive, Figtree
stonerealestate.com.au

Produced by DIAKRIT