

29 Abernethy Street Seaforth, NSW

5

4

4

Glamorous entertainer with Middle Harbour views ? access via Harvey St West

An executive residence of rare distinction and style, this impressively scaled residence has been expertly designed and superbly appointed to complement its exclusive harbourside cul-de-sac setting. Commanding Middle Harbour views dominate expansive living spaces and entertainers' terraces on both levels, and its beautifully landscaped gardens reveal water features and a heated pool and spa. Impressive in scale, design, construction and practicality!

Price:

Undisclosed



Maria Cassarino

0411 818 093



Maria Cassarino

0411 818 093



The floor plan is not to scale, measurements are indicative and in metres. All features included in this 3D plan are for inspiration purposes only. This is not an exact replica of the property or the position of exterior elements. Plans should not be relied on. Interested parties should make and rely on their own enquiries.

29 Abernethy Street, Seaforth

stonerealestate.com.au

Produced by DIAKRIT

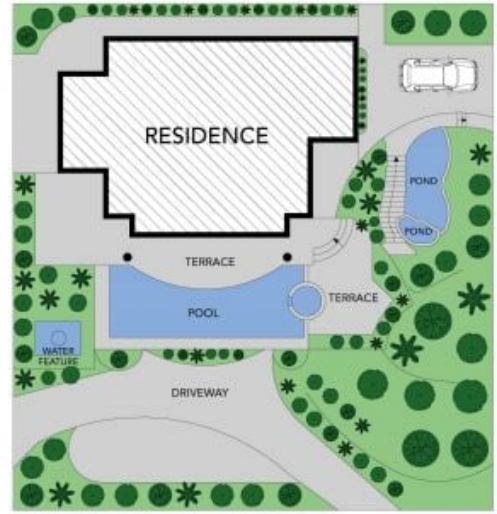
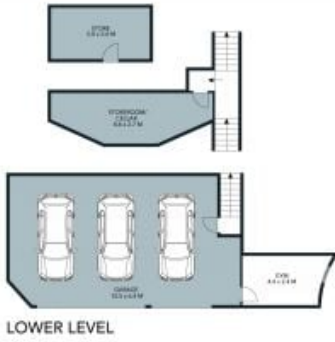

TOTAL LIVING AREA : 492 SQM

The site plan and floor plan are not to scale, measurements are indicative and in metres. Bushes and trees are placed for illustration purposes. Plans should not be relied on. Interested parties should make and rely on their own enquiries.



29 Abernethy Street, Seaforth
 stonerealestate.com.au

Produced by DIAKRIT