



19 Inverallan Avenue West Pymble, NSW

4 2 2

Private and beautifully appointed entertainer

Peacefully hidden behind a private garden, this beautifully renovated single level, full brick residence delivers perfect space and privacy, with an inviting family area flowing out to a level north to rear yard with an amazing alfresco area and spa/plunge pool with swim jets. Stroll to recreation parks, transport and esteemed schools.

- Enduring quality in double brick, high ceilings and ornate cornices
- Serene formal living with gas log fire, separate dining and casual living
- Exquisite designer kitchen, featuring induction cooking and Miele appliances
- Kitchen servery leads out onto sun-drenched patio and alfresco dining
- Generous double bedrooms, master complete with ensuite/walk-in robe
- Tastefully updated bathrooms with floor-to-ceiling tiles, ducted air conditioning
- Double lock-up garage with additional storage, internal laundry
- Walk to buses, shops, cafes, sporting facilities and prestigious schools

Price: Sold Off Market
Council Rates: \$448.00 p/q



Rob Szosta
0413 099 598



Sam Schofield
0468 310 412

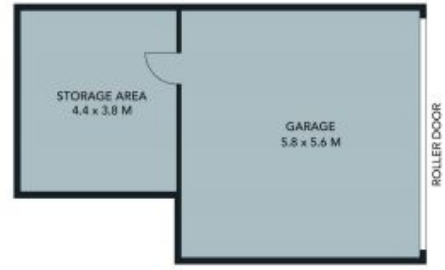

FIRST FLOOR

The floor plan is not to scale; measurements are indicative and in metres. Exterior elements are not in position. Plans should not be relied on. Interested parties should make and rely on their own enquiries.



19 Inverallan Avenue, West Pymble
 stonerealestate.com.au

Produced by DIAKRIT



FIRST FLOOR

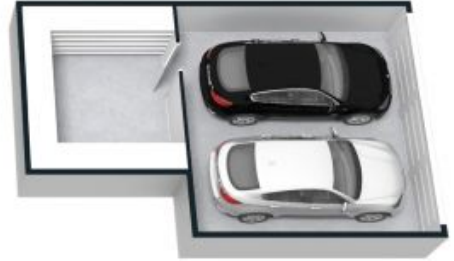

GROUND FLOOR



The floor plan is not to scale; measurements are indicative and in metres. All features included in this 3D plan are for inspiration purposes only. This is not an exact replica of the property or the position of exterior elements. Plans should not be relied on. Interested parties should make and rely on their own enquiries.

19 Inverallan Avenue, West Pymble
stonerealestate.com.au

Produced by DIAKRIT