



59 Gordon Street Manly Vale, NSW 2 Beds 1 Bath 1 Kitchen 2 Car

Family friendly home with large yard in ideal location

Charming character filled house in ideal location. Its quiet but pivotal position puts you within walking distance of supermarkets, buses, popular schools and it's a short cycle or drive into Manly, making it the ideal home for young and growing families. With a spacious internal floor plan and level back yard this home is sure to delight.

- Large living room opening on to a separate sunroom
- Oversized master bedroom
- Second bedroom queen size
- Original kitchen with ample amounts of storage
- Separate formal dining room
- Vast child friendly level backyard
- Pet friendly
- Internal laundry room off the kitchen

Price: LEASED
Available Date: 23/01/2019



Zoe Thackeray
0449 167 420



Eddy Piddington
0414 333 907



The floor plan is not to scale; measurements are indicative and in metres. All features included in this 3D plan are for inspiration purposes only. This is not an exact replica of the property or the position of exterior elements. Plans should not be relied on. Interested parties should make and rely on their own enquiries.

59 Gordon Street, Manly Vale
stonerealestate.com.au

Produced by DIAKRIT



(NOT IN POSITION)



(NOT IN POSITION)

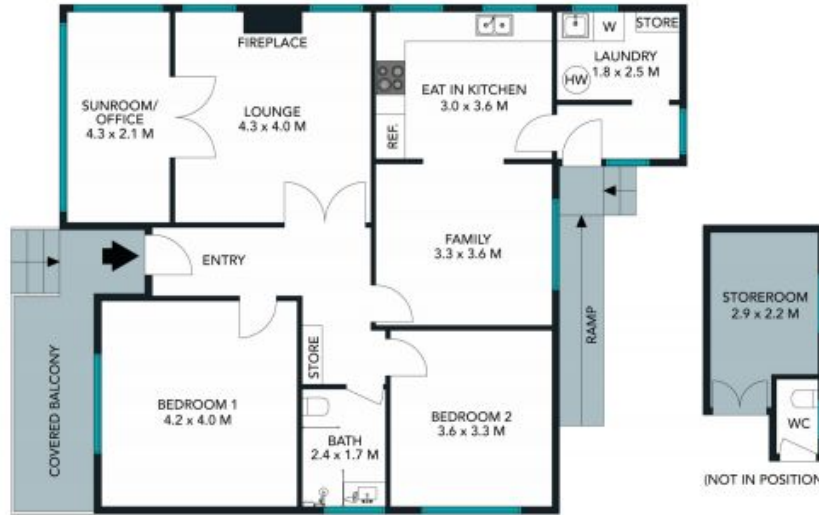

TOTAL LAND AREA : 140 SQM
TOTAL LIVING AREA : 98 SQM

The floor plan is not to scale; measurements are indicative and in metres. Exterior elements are not in position. Plans should not be relied on. Interested parties should make and rely on their own enquiries.



59 Gordon Street, Manly Vale
stonerealestate.com.au

Produced by DIAKRIT